

Quick Installation Guide

VIDEO DOOR ENTRY
MULTIUNITIES SERIES

VE02-03-04-06-08-10-12-A01

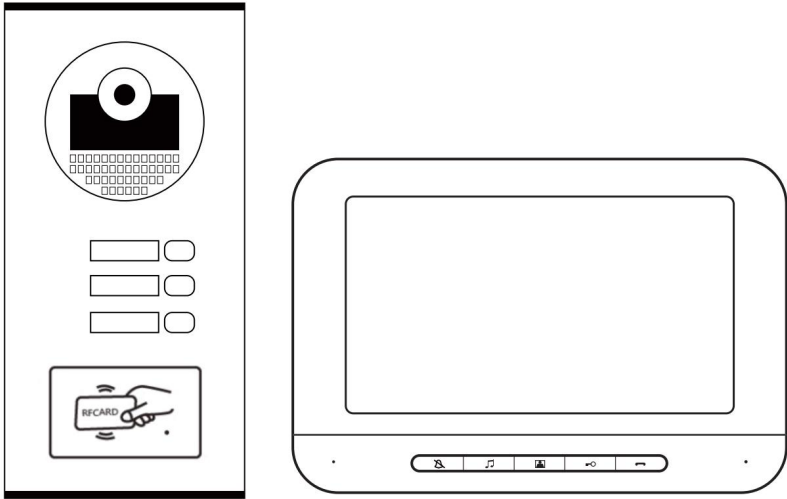

Please read the instructions carefully before use to ensure correct and proper operation.

1. Product Description

Product Introduction

This set of products is a color home intercom visual doorbell. The system consists of an outdoor unit and an indoor unit. The indoor unit is powered by network cable to realize doorbell call, intercom monitoring, remote unlock and network cable connection.

The display screen is LCD, the image is clear and transparent, and the color is gorgeous without distortion. The camera has an HD CMOS sensor. The outdoor unit can use an ID card to open the door. In case the outside light is insufficient, it will automatically start the infrared night vision illumination.

The door can be opened from the indoor unit. Outdoor unit requires 12-15V independent power supply, also indoor unit requires independent power supply.

The panel needs 12-15V power supply (recommended to use class V or VI network cable for connection, 2-core or 1-core), and the maximum service distance is 150m.

2. Product introduction

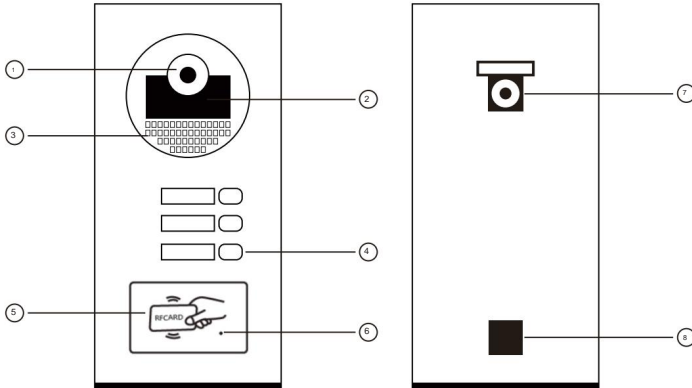
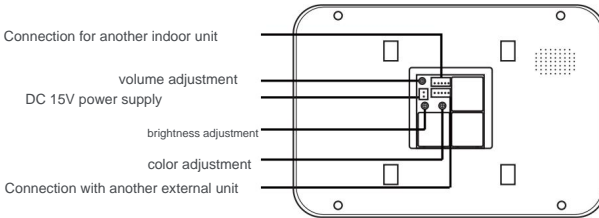
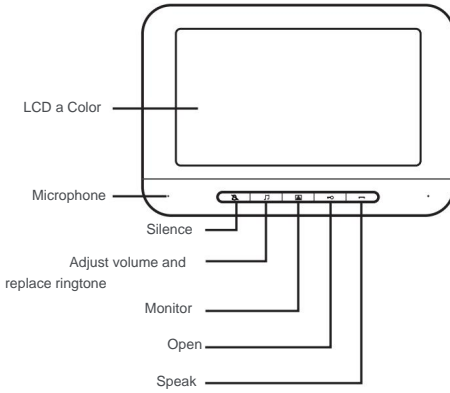

- 1) Camera
- 2) Infrared LED
- 3) speaker
- 4) Bell button
- Card reading area
- 5) microphone
- 6) microphone
- 7) Area address setting zone
- 8) electronic lock sign

3. Parameters

indoor unit	
screen	TFT LCD 7"
Resolution	800*480
Material :	ABS plastic
Power	Standby: 1W Working: 10W
Voltaje	12-15V 1.2A
Operating Temperature	-20 °C ~60 °C
Monitoring time	90 seconds
Communication time	90 seconds
Ringtone	25 tones
Installation Mode	Wall Mounted
Signal Interface	5P x 2.54

outdoor unit	
camera	CMOS HD
Aluminum	alloy
Cards	Number of cards: 500
IR distance	0.2-1m
Power supply	Special power adapter DC15V
Power	-20°C ~60°C
Camera Angle	82°
Degree of Protection	IP54
Unlock	signal Voltage signal
Operating Temperature	-20 °C ~60 °C
Installation mode	Recessed installation
Signal Interface	5P x 2.54

4. Indoor unit operation

a. Set indoor unit ringtone

1. Ringtone setting

In indoor unit standby mode, firstly press " " button to turn on the screen, and then press " " button to turn off the buzzer and intercom, without affecting the image display.

If you need to turn on the doorbell and intercom, please press the " " button again in monitor mode " " .

The interruption free mode will be activated after activating the mute function.

2. Change ringtone

In indoor unit standby mode, press " " button first to turn on the display, and then press " " button to turn on ringtone and enter "change ringtone" setting. The system is equipped with 25 ringtones of different lengths. The last ringtone will be the ringtone when the system is

3. Ringtone volume adjustment

In indoor unit standby mode, press " " button first to turn on the display.

Press " " button, the buzzer will ring to enter the buzzer setting, it has three levels: large, medium and small. Press for two seconds at a time to gradually increase or decrease the volume.

If the device is powered off, all ringtone settings will be restored to factory settings.

b. Instructions for the operation of the doorbell

1. When any visitor presses the call button of the outdoor unit, the screen of the indoor unit will display the outdoor image in real time and the doorbell will sound.



2. The indoor user can press the button "  to talk to the visitor.

Note: press the " " button for the first time to open the call, the second time you press call. The screen will automatically  will close the turn off after 30 seconds of no response.

3. In intercom mode, indoor user can press "  to open the door.

4. In intercom mode, indoor user can press "talk" button, it will end automatically in 90 seconds.  to finish speaking, or the

5. If it is necessary to resume the conversation after hanging up, press the " " button first and then the "  button to talk to the visitor.

6. In indoor unit standby mode, press " " button first and then " " button to open the door; the screen will turn off automatically  in 90 seconds, or you can turn it off by pressing the "  a

5. ID card instructions

1. Management card creation: management switch key up, the outdoor unit is turned on (sounds "Di"), the first system defaults to add the card (sounds "Di"), and the second system defaults to delete the card ("Di" sounds), then power off, lower the management switch key, and the management card is done.

2. Add user card: when the outdoor unit is in power-on standby mode, swipe the management card ("Di" tone), then swipe the user card ("Di" sounds), and increment continuously. For each additional card ("Di" sounds), after swiping the user card, finally present the management card to exit ("DiDi" sounds twice), and the user card addition will be finished.

3. Delete single user card: when the outdoor unit is in standby mode, slide to delete the card ("Di" sounds once), then swipe the user card to be deleted (place on the swipe area of the card for 2 seconds, "Di" beeps once, and then "Di" beeps again 2 seconds later), clear continuously, swipe each card ("Di" beeps once), and finally present the management card after swiping the card to be deleted ("DiDi" beeps twice), the card deletion is complete.

4. Delete all user cards: when the outdoor unit is in standby mode, slide to delete the card (sounds "Di"), then slide to add the card (sounds "Di"), and then slide to delete the card. card again to exit ("Di" beeps once, and "DiDiDiDiDi" beeps seven times after 2 seconds). All user cards are deleted.

5. Invalid card swipe: "DiDiDi" beeps three times continuously.

6. Installation

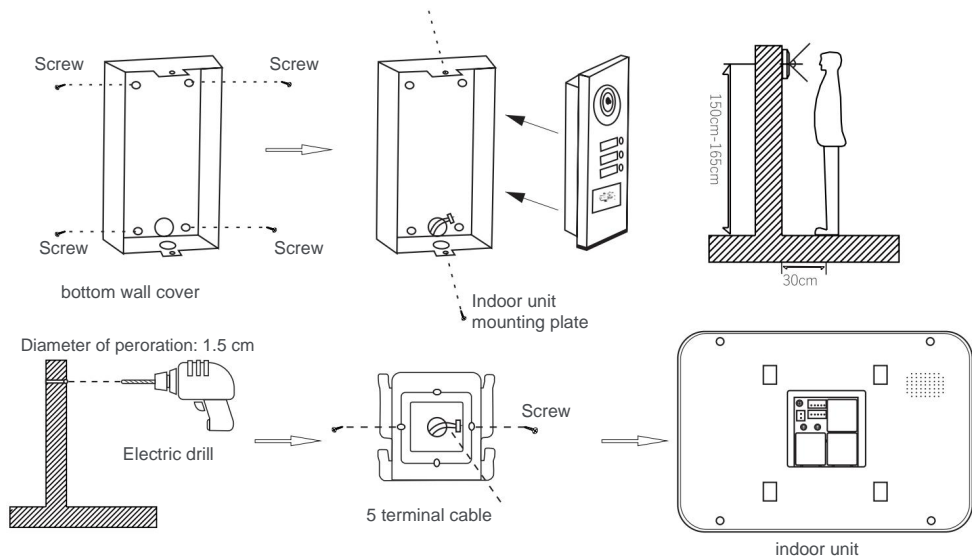

7. Product diagram

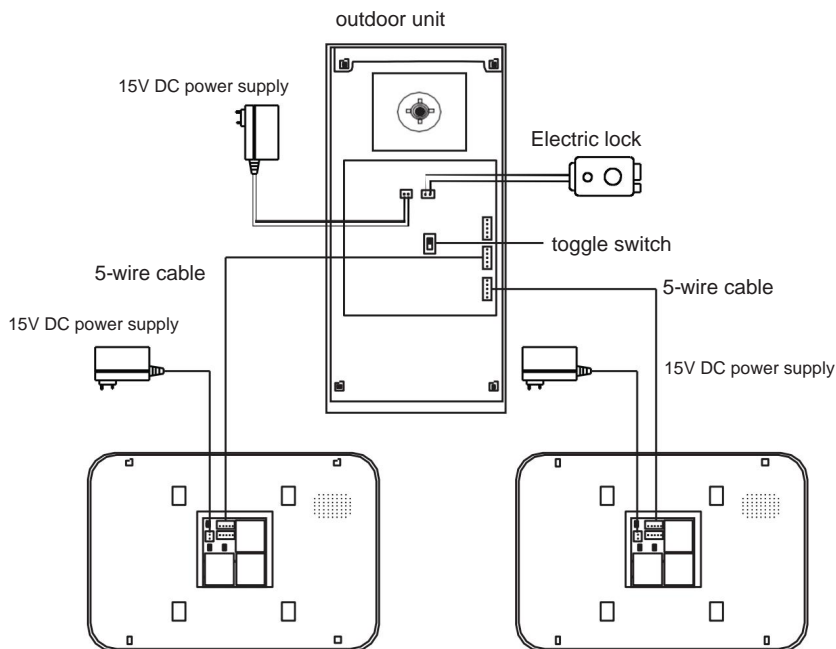



www.zkteco.com



www.zktecolatinoamerica.com



Copyright © 2022, ZKTeco CO., LTD. All rights reserved.
ZKTeco may, at any time and without prior notice, make changes or improvements to products and services or stop their production or marketing.
ZKTeco logo and brand are owned by ZKTeco CO., LTD.