

MS8392-EV Optional Accessories - Installation Guide

1. Pendant Mount

A pendant head (AM-118) and an adaptor (AM-525) are required.

You can either use standard pendant pipes, AM-116 (20cm), AM-117 (40cm), or use NPT pipes with the AM-522 adaptor and a user-supplied female-female NPT adaptor.

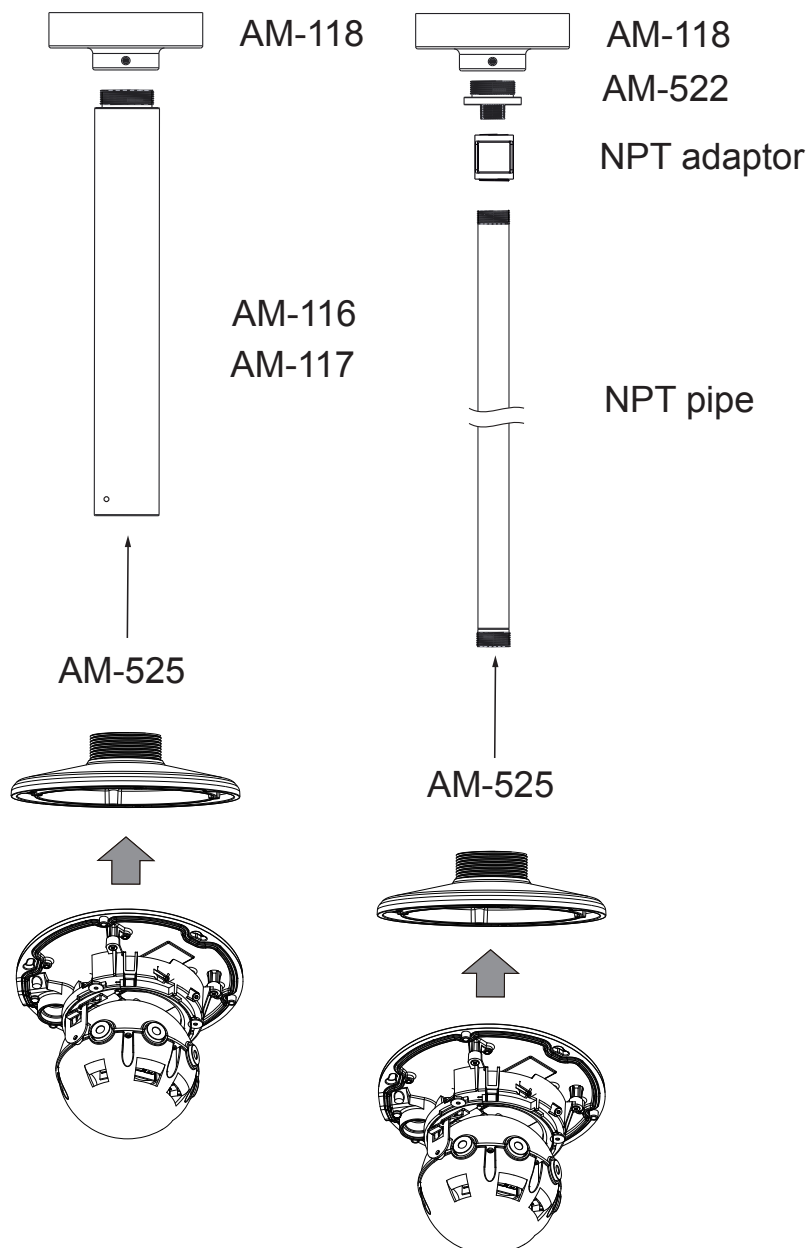

Using the 3/4" NPT Pipe

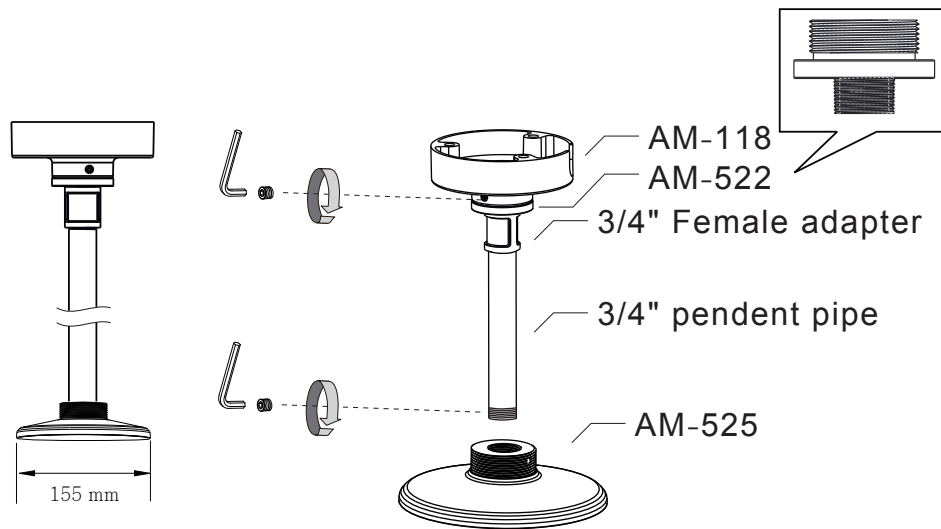

1. Determine a hard surface ceiling location, and use the included alignment sticker for marking three mounting holes as where the holes will be drilled to secure the pendant head.
2. Hammer in the plastic anchors.

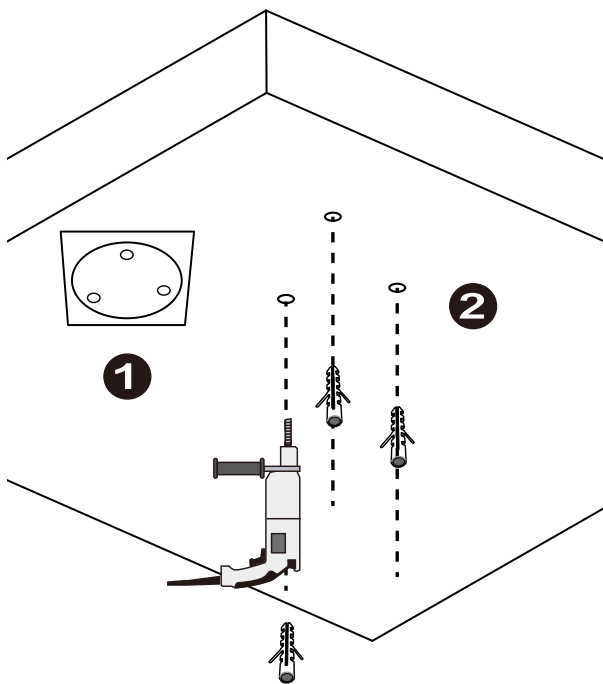

3. Secure the pendant head using the included screws.
4. Install the AM-522 adaptor and the NPT female-female coupler (user-supplied)
5. Tighten the retention screw using the hex wrench.
6. Install the 3/4" NPT pipe of a preferred length.
7. Install the AM-525.
8. Install the camera to AM-525 using the 3 mounting holes.

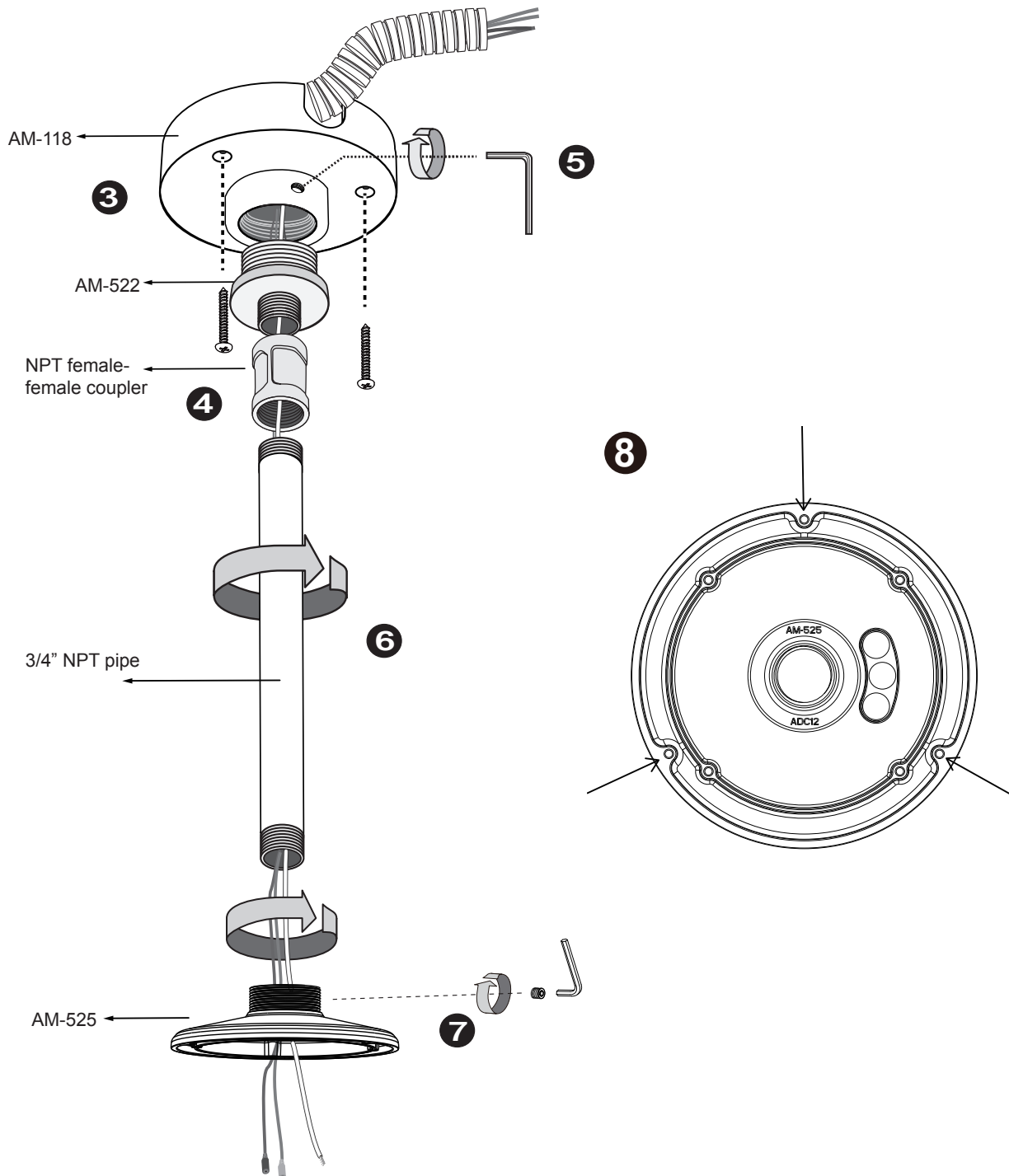

2. Using the Wall Mount Bracket

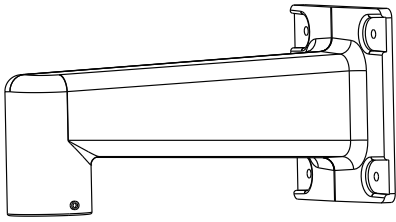

AM-218

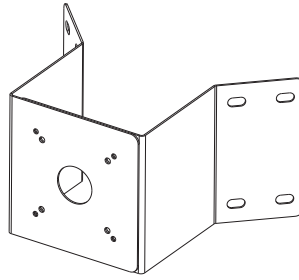

AM-412

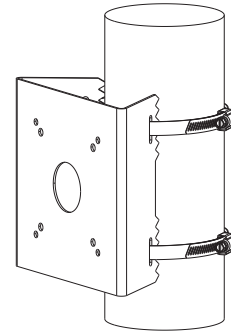

AM-312

Mounting Hole Definitions for AM-714

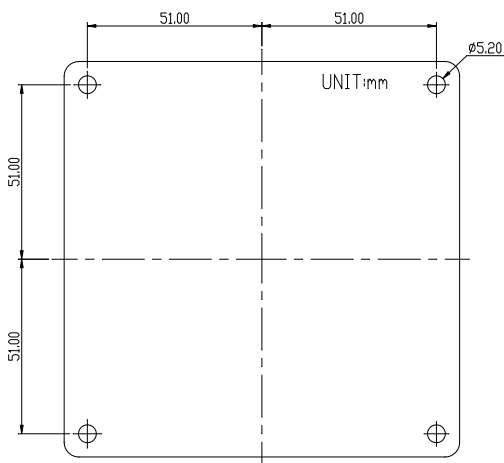

The AM-714 conduit box is an optional accessories.

To install the conduit box,

1. Use the included alignment sticker on a preferred position. Drill holes on the wall and install the junction box. If space behind the wall allows, you may also pass cables through the wall. Note that an NPT pipe is still recommended if the connection goes through a wall. Make sure water can not enter the drilled hole. Use silicon or caulk the drilled hole to prevent water leakage. .

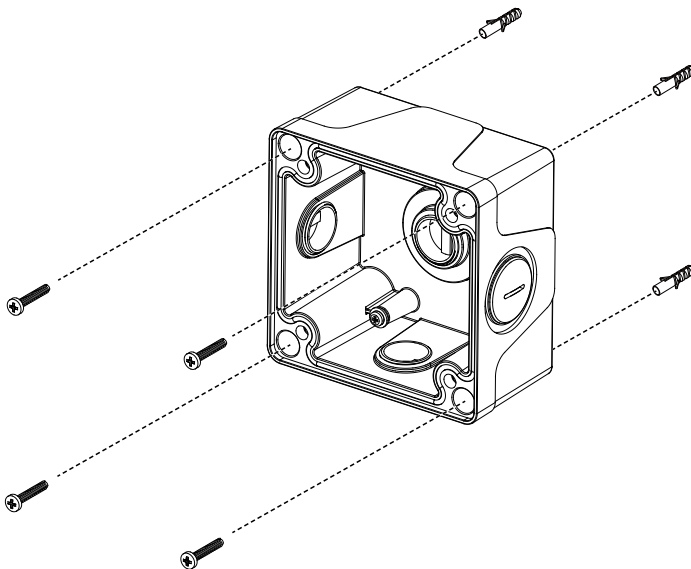

2. A 3/4" conduit is required for routing the cables with waterproof connection.

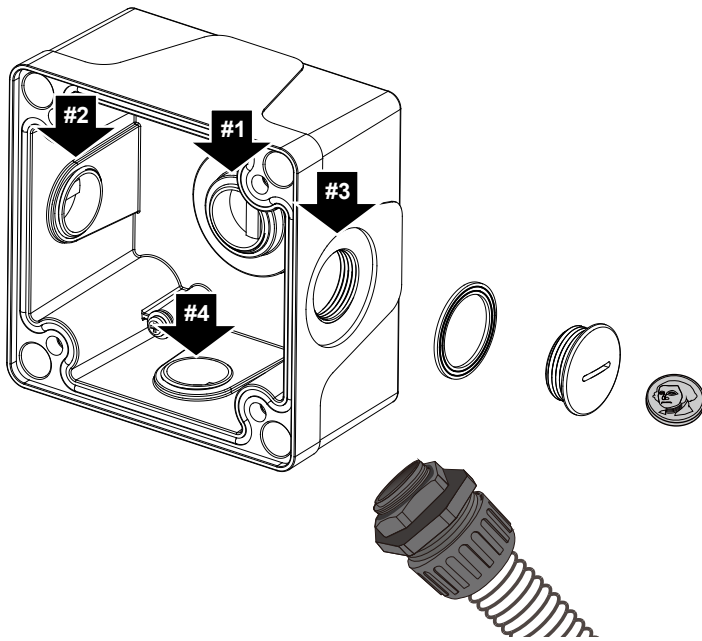

3. Install the cable gland and pass cables through it. Form a drip loop when routing with the conduits.

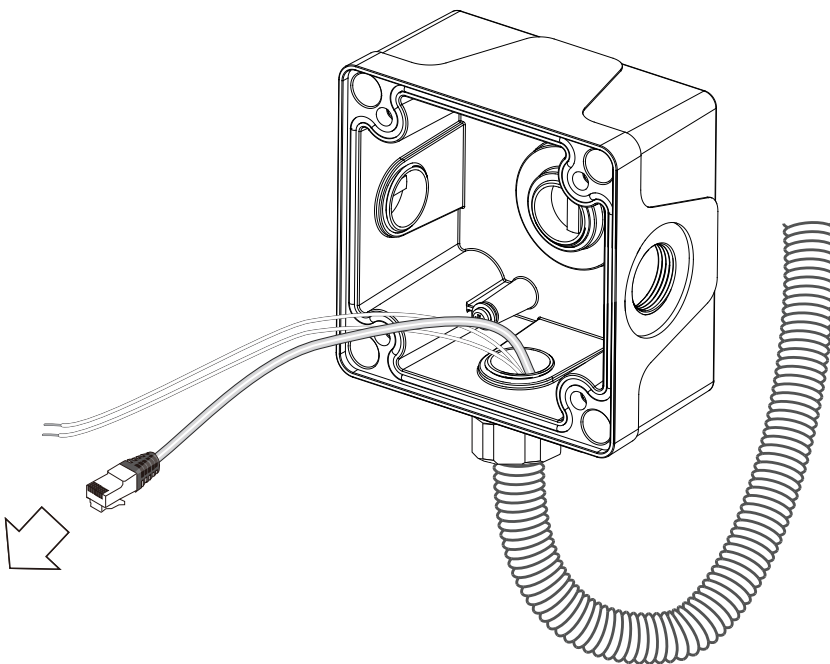

4. Route cables through the AM-218 wall-mount bracket and the adapter (AM-525), and Secure the bracket to the conduit box using the included screws.
5. Secure the adapter by turning it clockwise.
6. When done, fasten the hex socket screw to secure the connection.
7. Install the camera to the AM-525 adaptor. See camera's User Manual for how to install the camera and cabling.

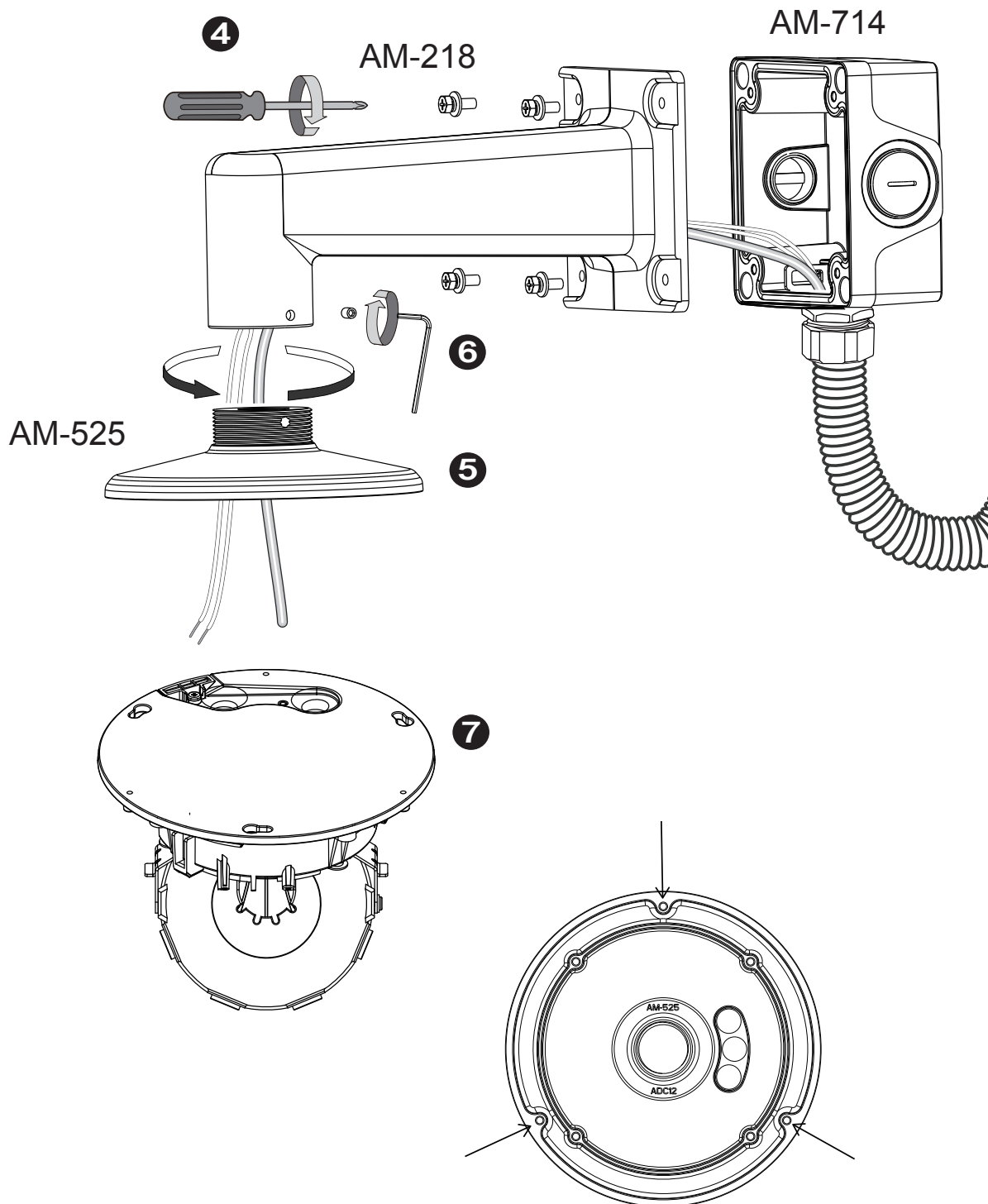

Using the AM-312 Pole-mount bracket

Below are the components of the AM-312 pole-mount bracket.

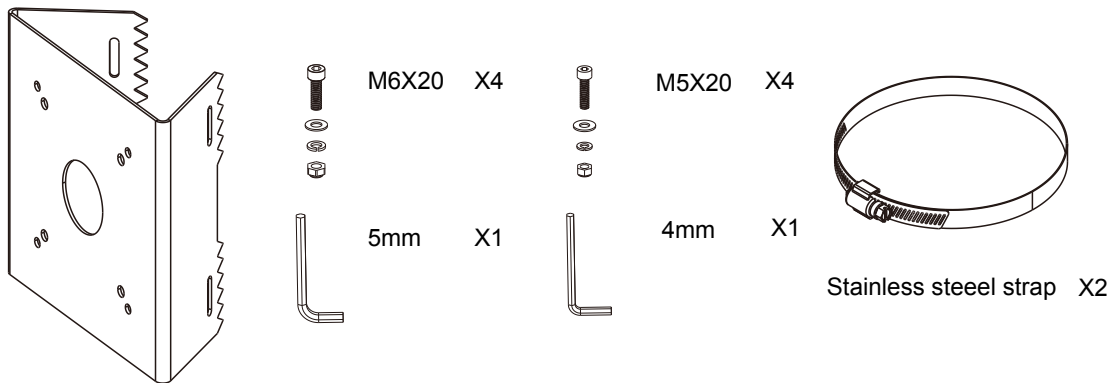

AM-312 Pole mount bracket dimensions

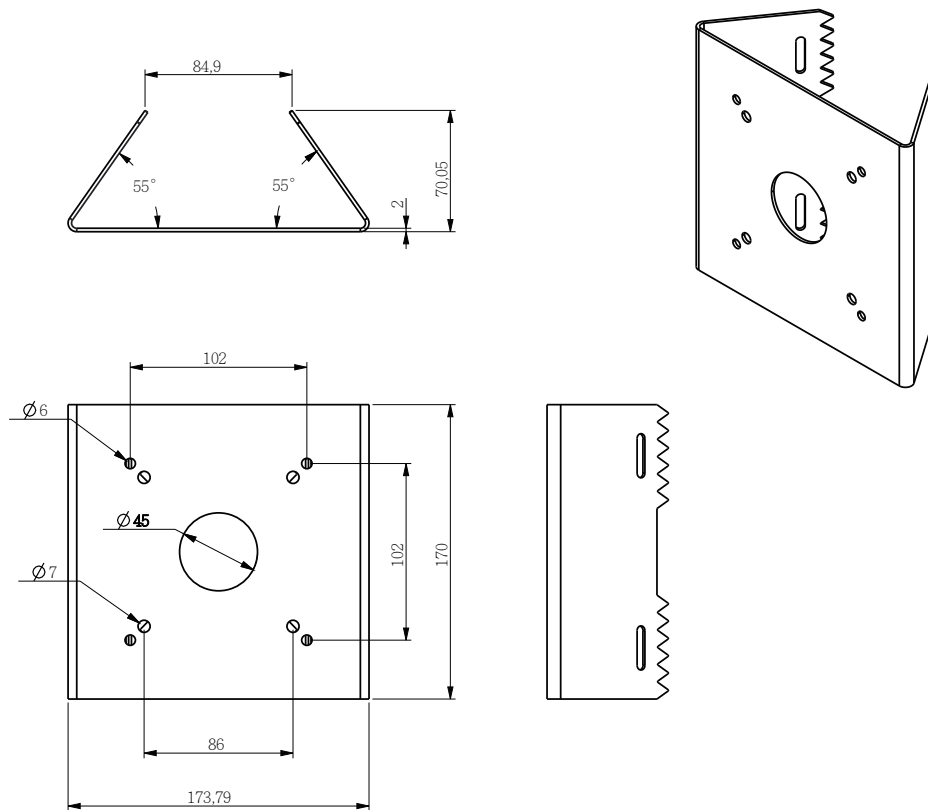

The pole mount bracket is designed to accommodate a pole in a diameter ranging from 90 ~ 152mm (3.5 ~ 6 inches).

Below is a general, sample procedure using a Pole mount bracket:

1. The 4 screw holes in the center are used for directly mounting the AM-218 wall-mount bracket. The 4 screw holes at the edges are used for mounting the AM-714 conduit box.

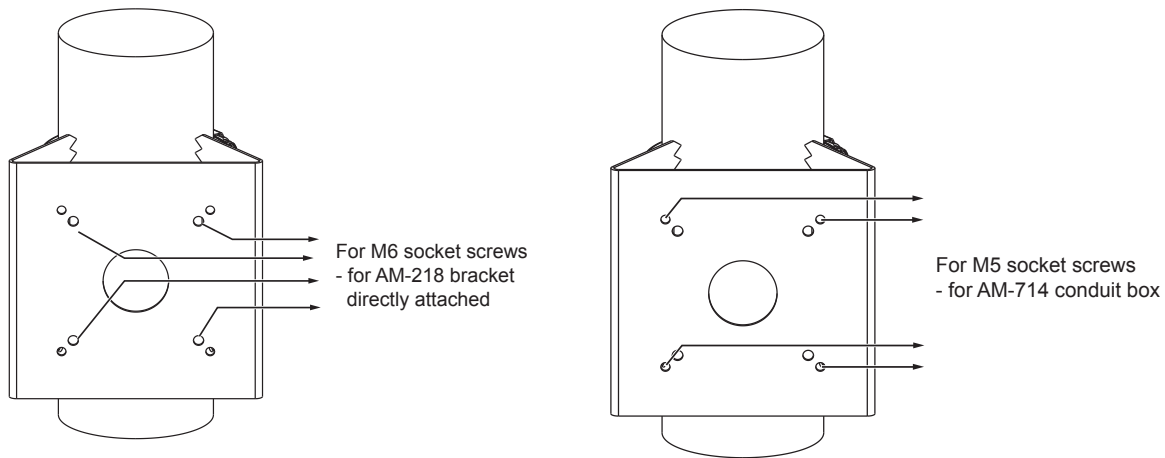

2. Route power lines and other cables through the included cable gland, pass them through conduits (separately purchased), and install the cable gland through the AM-312, and to the AM-714 conduit box.

Note that AM-714 is optional. To install the box, secure it to the pole bracket using 4 M5 socket screws, washers, and nuts. You can still install the AM-218 bracket without the conduit box.

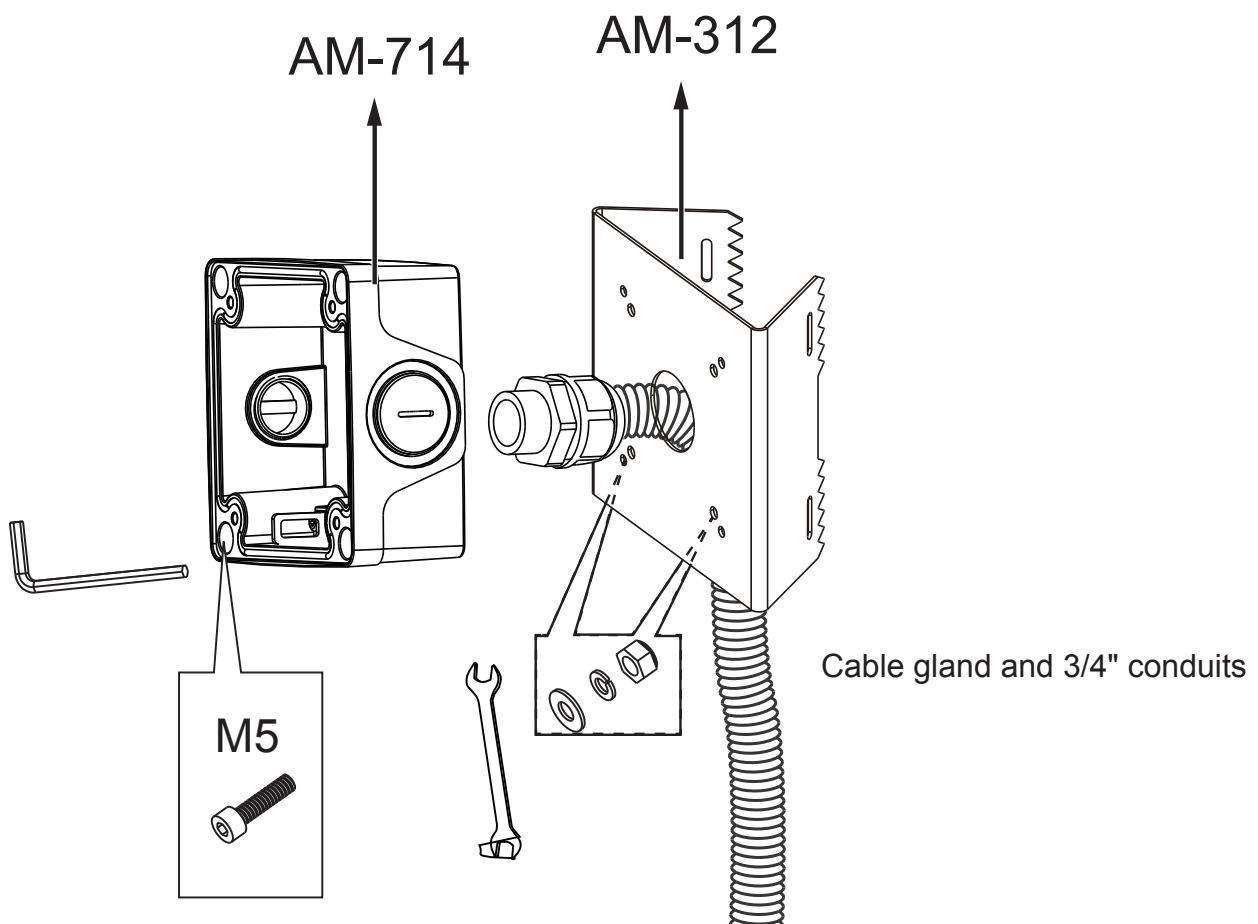

3. Pass the stainless steel straps through the bracket and around the pole.
4. Tighten the straps using a pincer plier and a flat blade screwdriver.

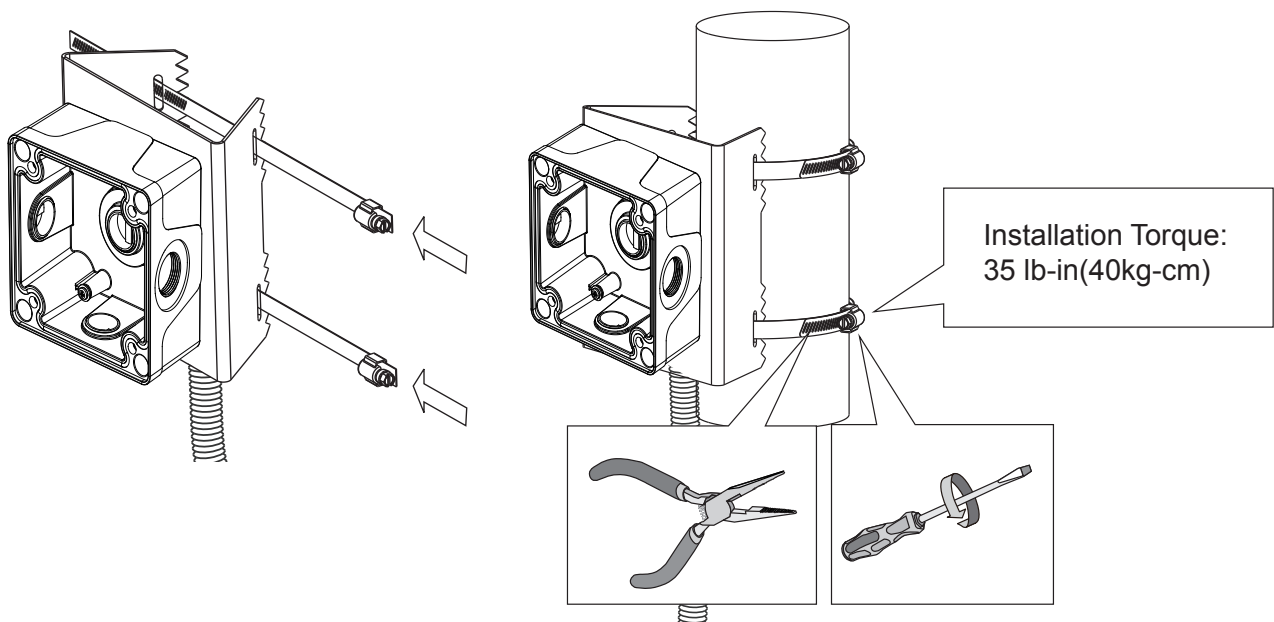

5. Install the AM-218, AM-525 using the M6 socket screws and nuts.
6. Secure the connection by tightening hex socket screw on the side of the bracket.
7. Install the camera.

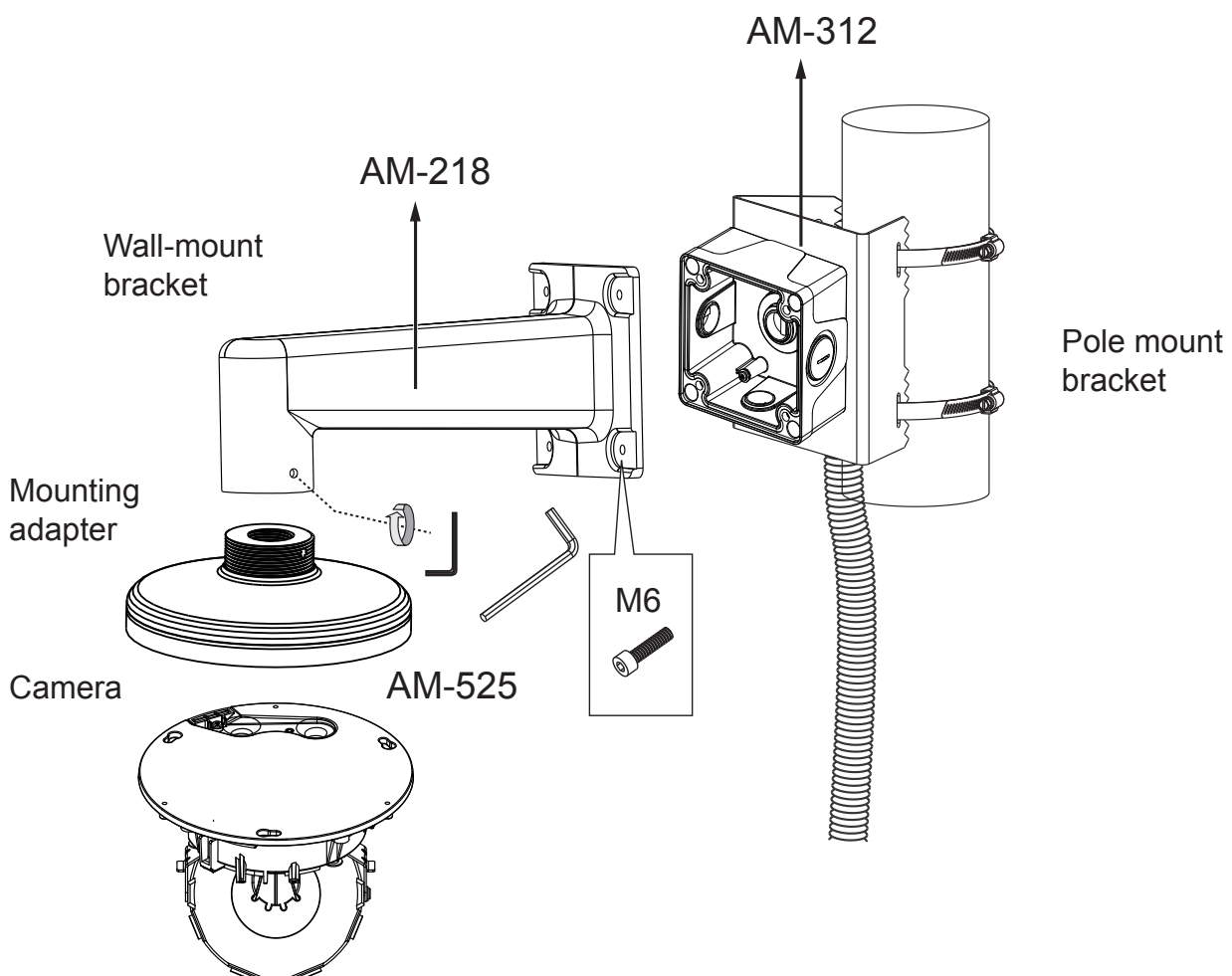

3. Using the AM-51C Electrical Box Adapter

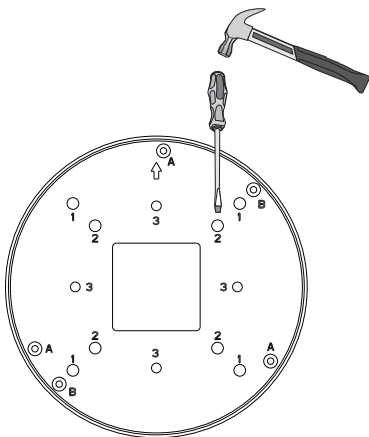

Use a hammer and screwdriver to open the knock out holes you prefer to use.

Below are the locations of different groups of mounting holes for matching different junction boxes:

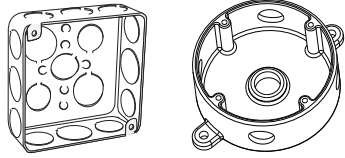
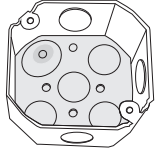
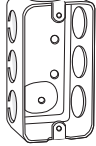
Hole Type	Applicable Box	Drawings	Screw	No. of screws
1	4" square and round box		#8-32, L15 (User-supplied)	2
2	4" octagon box		#8-32, L15 (User-supplied)	2
3	1" single gang box		#6-32, L15 (User-supplied)	2

Installing the Mounting Cap

1. Route cables through the junction box.

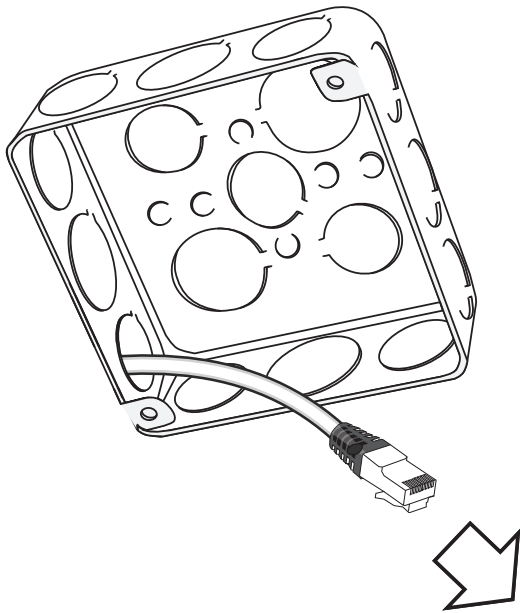

2. Install the mount cap to the junction box. Use screw holes specified on the previous page depending on the type of junction box.

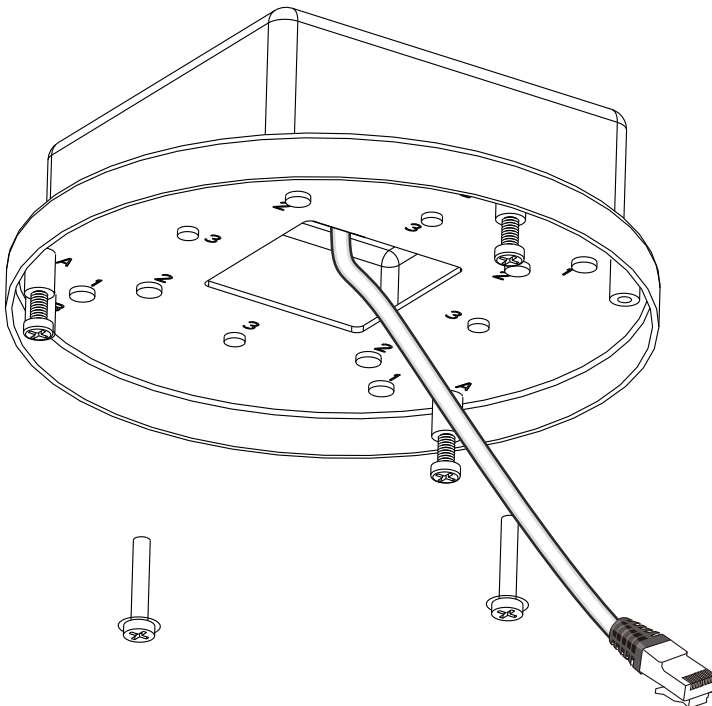

3. Fasten screws to the mounting cap. Do not completely tighten the screws. Leave part of the screws out.

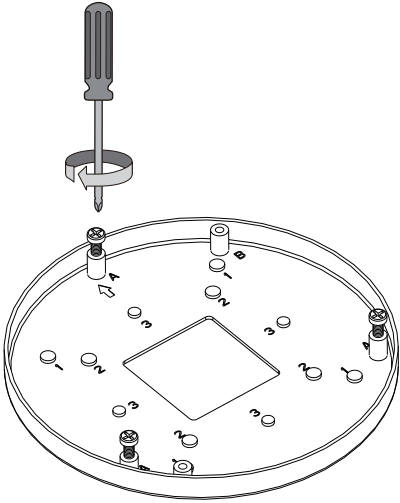

Attach the plastic stopper to the opening at the bottom of the camera.

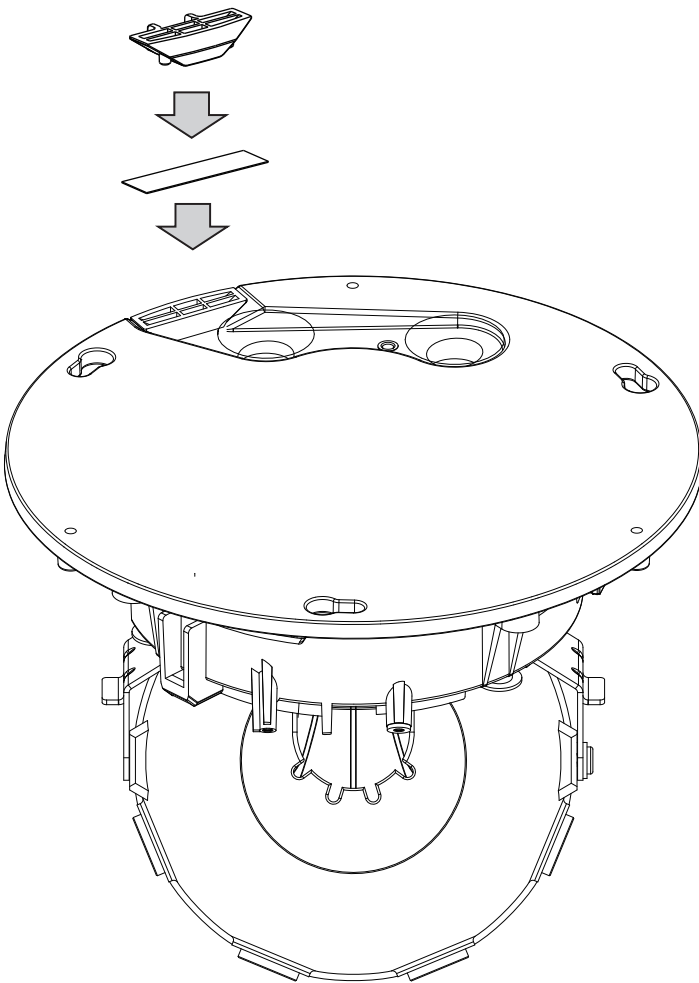

4. Install the camera to the mounting cap by turning it counter-clockwise so that the screw heads fit in the keyhole slots. Fasten the screws, and then connect the cables.

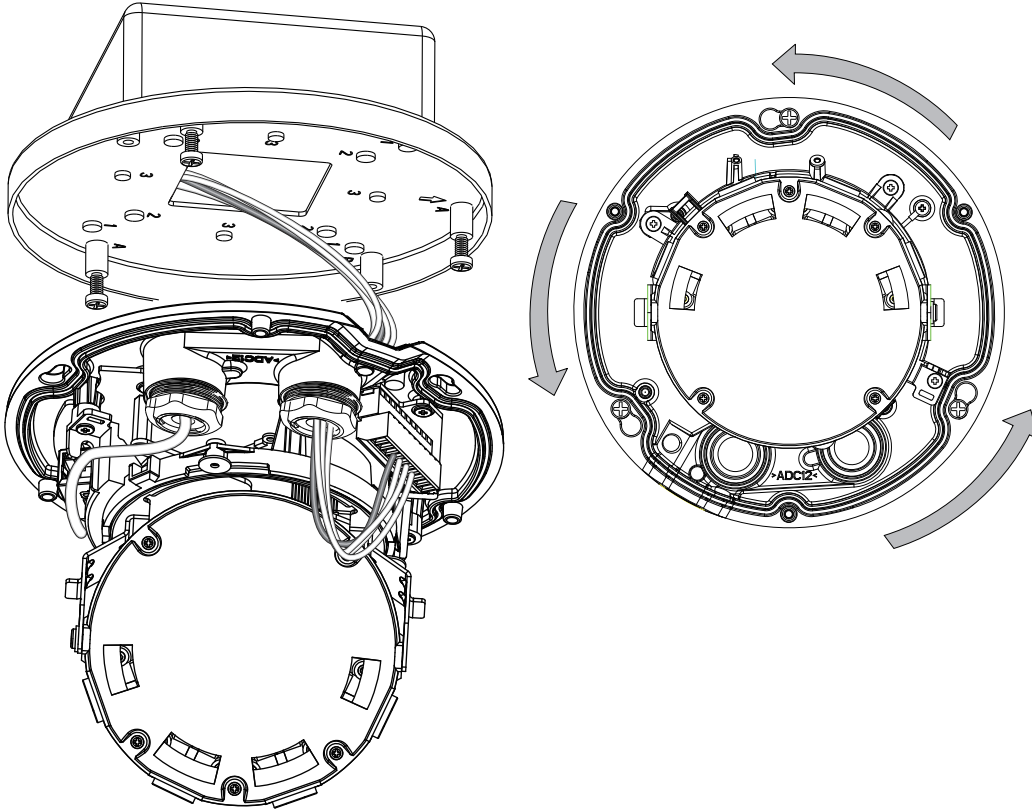

Refer to the camera's User Manual for how to make the waterproof connections.

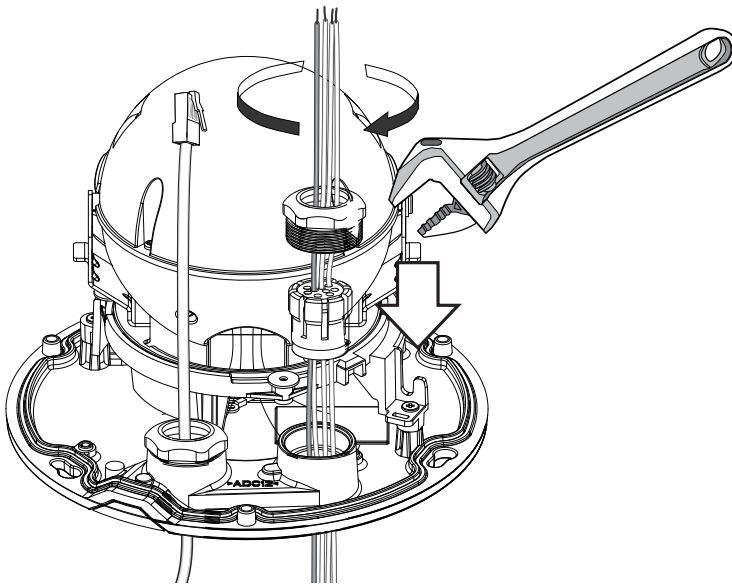

5. Tune the shooting angle. Install the dome cover.

⚠ IMPORTANT:

Replace the desiccant bag whenever you open the top cover. This ensures the components are free from the moisture.