

The company passed the ISO9001: 2008 quality management system standard

Wulian[®]

**Smart Dimmer Switch
(Brazilian Type, One-Gang, L)**

User Manual

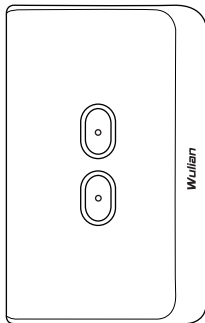

©2015 Nanjing IOT Sensor Technology Co., Ltd.
Publication Number: 2015-0619.V01

Welcome to Use Smart Dimmer Switch (Brazilian Type, One-Gang, L) User Manual

- **Wulian** is the registered trademark of Nanjing IOT Sensor Technology Co., Ltd. All the other trademarks and registered trademarks mentioned in this manual are trademarks or registered trademarks of their respective owners.
- Please read this manual carefully for the proper use of this product.
- Smart Dimmer Switch (Brazilian Type, One-Gang, L) (hereinafter referred to as “this product”) are smart home control products produced by Nanjing IOT Sensor Technology Co., Ltd. (hereinafter referred to as “Wulian”). This product shall be used with smart home APP as well as the supplied accessories. Wulian is not responsible for any loss due to improper installation and usage of this product.
- Please check the Wulian website periodically for manual and APP update availability and the relevance.
- Without the written permission of Wulian, any individuals and enterprises shall not copy all or part of the contents of this manual, or use our registered trademark. Any illegal use of our trademarks shall be investigated according to law.
- For more information about smart home products, please visit: www.wulian.cc/english

Product Illustration

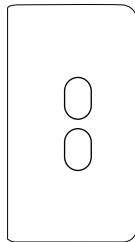
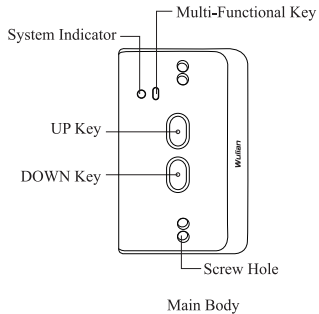

Features

- Realize local & remote control for devices by smart mobile terminal to adjust lighting intensity.
- Make linkage with binding switches to realize several switches control one device or one switch controls several devices.

Software Download

Option A:

Download the latest smart APP by scanning QR code on the package box of this product.

Option B:

iOS user can download the APP by searching "Wulian Smart home" in "APP Store".

Android user can download the APP by searching "Wulian Smart home" in "Google Play".

Warm prompt: For the first use, please download smart home APP and read user manual carefully. Please pay attention to Wulian information to download the latest APP in time.

Installation Instruction

1. Connect wire in the wall inner box with terminals of this product.

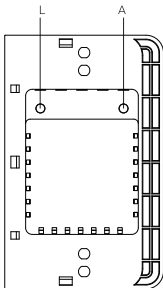

Port	Wiring
L	Live Line
A	Load Output

Notes: Cut down the power before installation! It's dangerous to operate with power on. Non-professional operation is strictly prohibited.

2. Remove housing. Fix this product in the inner box via 2 pieces of screw (Installation method is same as that of common wall switch).

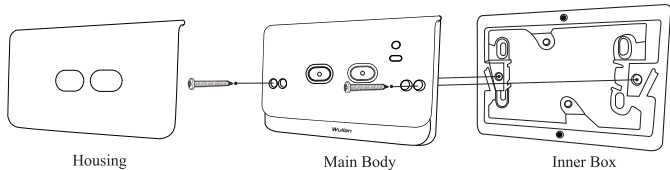

3. Close housing to finish installation (Join the network before installation).

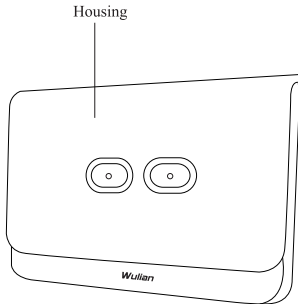

Network Setting

1. Add ZigBee Network

Quickly click [Multi-Functional Key] 4 times to apply for joining ZigBee network. While searching for networking, [System Indicator] is flashing in green 4 times. After joining ZigBee network successfully, [System Indicator] stays green 2 seconds, and then goes out.

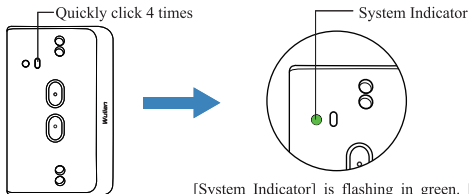

2. Binding Setting

Long press [Multi-Functional Key] while quickly click [UP Key]. Then loosen [Multi-Functional Key], [System Indicator] flashes once to send binding request. Operate the binding of the other end of device within 20 seconds. If binding succeeds, [System Indicator] flashes 3 times. If it fails, [System Indicator] flashes 6 times.

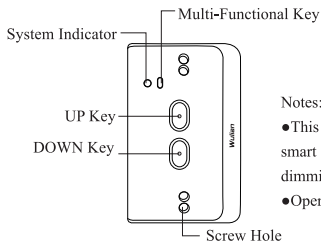

Notes:

- This product can bind with remote control device such as smart scene switch. It needs twice bindings respectively for dimming up/down the device.
- Operating methods of unbinding is same as that of binding.

3. Exit ZigBee Network

Long press [Multi-Functional Key] 10 seconds. [System Indicator] is flashing in green 4 times, and then goes out. This product restores to factory setting, and exits ZigBee network.

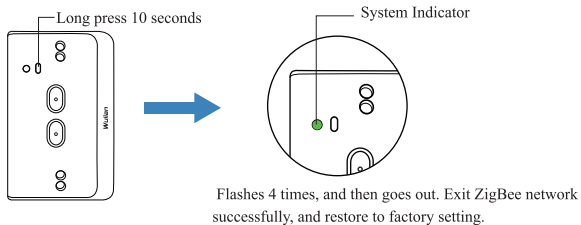

Notes:

- Before setting, please make sure the gateway (additional purchase) works normally. Ensure that this product is within the effective communication range of the gateway. If it needs remote control, please connect gateway to wide area network.
- When this product needs to add other gateways, please exit ZigBee network, and then join the network.

User Guide

1. Click [UP Key] to dim up light device to be lightest. When light device is dimming up, click [UP Key] once, and light keeps current brightness. Click [UP Key] again to dim up device to be lightest.
2. Click [DOWN Key] to dim down light device to be dimmest. When light device is dimming down, click [DOWN Key] once, and light keeps current brightness. Click [DOWN Key] again to dim down device to be dimmest.

Cautions

- Cut down the power before installation! It's dangerous to operate with power on. Non-professional operation is strictly prohibited.
- This product must be installed in the plastic box! Installation in the metal cassette may weaken wireless communication signals so that it may lower the communication efficiency.
- This product should be installed in dry and clean place to prevent inner component from dampness or other debris.
- If this product breaks down, non-professional staff shall not handle it. Send it to local service center for repair, or contact our customer service staff.

Specification Parameter

Structure Parameter

Overall Dimension (L × W × H, mm)	116.5 × 75 × 36.4
Material & Color	PC+ABS、White
Flame Retardant Rating	UL94 V-0
Net Weight(g)	130

General Parameter

Power Parameter	127V, 220VAC, 60Hz
Standby Power Consumption	≤0.5W
Load Capacity	300W Resistive Load (Incandescent Lamp / Halogen Lamp)

Specification Parameter

Structure Parameter

Overall Dimension (L × W × H, mm)	116.5 × 75 × 36.4
Material & Color	PC+ABS、White
Flame Retardant Rating	UL94 V-0
Net Weight(g)	130

General Parameter

Power Parameter	127V, 220VAC, 60Hz
Standby Power Consumption	≤0.5W
Load Capacity	300W Resistive Load (Incandescent Lamp / Halogen Lamp)

Minimum Load	25W
Working Temperature/ Humidity	-10°C ~ +45°C/≤95%RH (Noncondensing)

Radio Frequency Parameter

Communication Protocol	IEEE 802.15.4 ZigBee/SmartRoom
Antenna Type	PCB Antenna

Purchasing Information

Product Name	Smart Dimmer Switch (Brazilian Type, One-Gang, L)
Model	WL-ZCSWNPW-D1115-01
Material & Color	PC+ABS, White
Item No.	WLPN140630003

Building 11, No.15, Fengji Road, Yuhuatai District, Nanjing (P. C.: 210039)
Email: overseas@wuliangroup.com
Service Hotline: 400-889-2891
www.wulian.cc/english