

Disclaimer

This guide is for informational purpose only. Working with electricity can be dangerous unless proper safety precautions are taken. If you are not comfortable or are inexperienced with the processes and tools described in this manual, we recommend that you hire a licensed electrician.

About the Guide

- All the design and software here are subject to change without prior written notice.
- All trademarks and registered trademarks mentioned are the properties of their respective owners.
- Please visit our website or contact your local service engineer for more information.
- If there is any uncertainty or controversy, please refer to our final explanation.



Installing Camera

WARNING

Risk of electrical shock.

- Be sure to disconnect the power at the fuse or circuit breaker before installation.
- Verify that the supply voltage is correct. Connect fixture to a 100 ~240VAC 50/60 Hz power source.
- Properly ground fixture.
- Always follow code standards when installing wired connection.
- We strongly suggest you hire a licensed electrician to install the camera.

Risk of fire.

- Do not connect near combustible or flammable surfaces.

Note

- Do not connect this light fixture to a dimmer switch or timer.
- Make sure the mounting surface is strong enough to hold at least three times of the device weight.

Step 1 With power off at the breaker, remove the existing floodlight from the junction box it is attached to and disconnect the wires. Inspect the junction box to make sure water cannot get into it.

Step 2 Install the mounting plate:

- With junction box

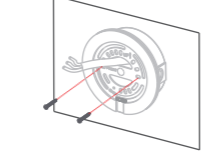

Stick the mounting plate to the junction box.

- Without junction box

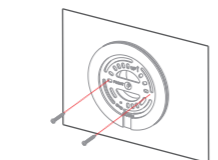

Install the mounting plate to the middle of the opening with the expansion bolts and self-tapping screws.

Note

- If there is a mounting plate attached to your junction box, remove that as well.
- If you do not have an existing junction box, you will need to hire a licensed electrician to install one. Also be sure to comply with your local codes.

Step 3 Turn the adjustment knobs to loosen the lights, and then adjust the light angles to give space to the mounting screw.

Step 4 Hook one end of the hook into the hole on the mounting plate, and the other end to the edge of the camera, so you can free your both hands for the installing.

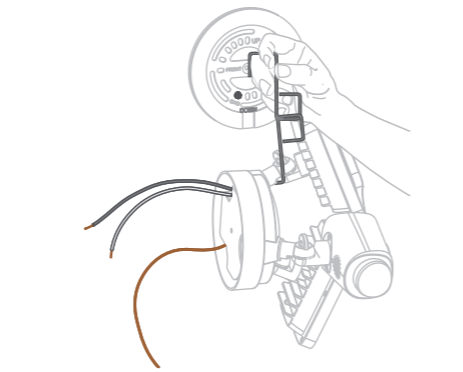

Step 5 The copper wire from the camera is ground wire. Connect the ground wires together. Use one of the supplied wire nuts if necessary.

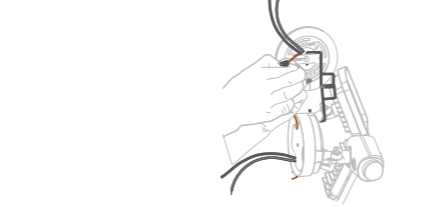

Step 6 Connect the power wires.
-The white wire from the camera is neutral wire, connect this wire to the reserved neutral wire.
-The black wire from the camera is hot wire, connect this wire to the reserved hot wire.
Fix those two joints with wire nuts .

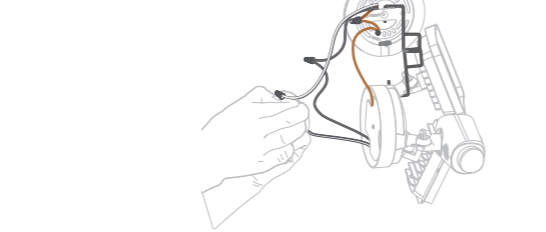

Step 7 Put away all the wires, attach the camera to the mounting plate, and fix the camera with mounting screws.

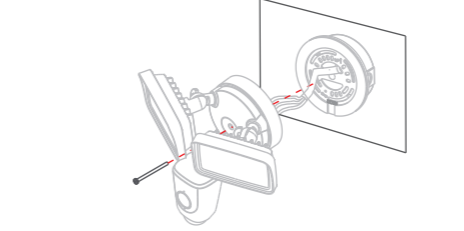

Step 8 Adjust the light and lens angle, and keep the PIR detector parallel to the ground to ensure optimal detection.

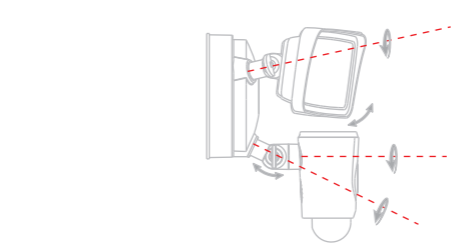

Operating With Imou App

Step 1

Power on the camera.

Step 2

Scan the following QR code or search "Imou" in Google Play or App Store to download and install Imou App.

Note

If you have installed the App, update it to the latest version.



Step 3

Run Imou App, and then register an account for first use.

Step 4

Wait for booting to be finished, and then the camera indicator flashes with green light.

Step 5

Connect your smart phone to your Wi-Fi network, and make sure your smartphone is connected to Wi-Fi network with 2.4 GHz band, and then do the following operations to finish adding camera.

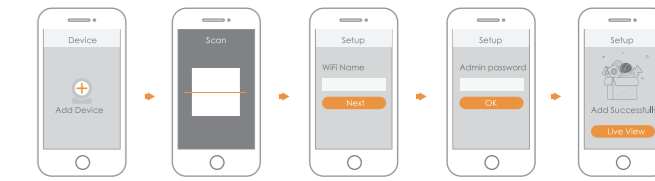

Note

- If you have more than one camera, do step 5 to add them one by one.
- If the Wi-Fi network changed or the indicator status goes wrong, reset the camera, and then do step 5 to add it again.

Imou

Quick Start Guide

Version 1.0.0

Packing List



Floodlight Camera ×1



Mounting Plate ×1



Screw Package ×1



QSG ×1



Hook ×1



Mounting Screws ×1



Bracket Screws ×4

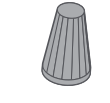

Wire Nut ×3

Assembly

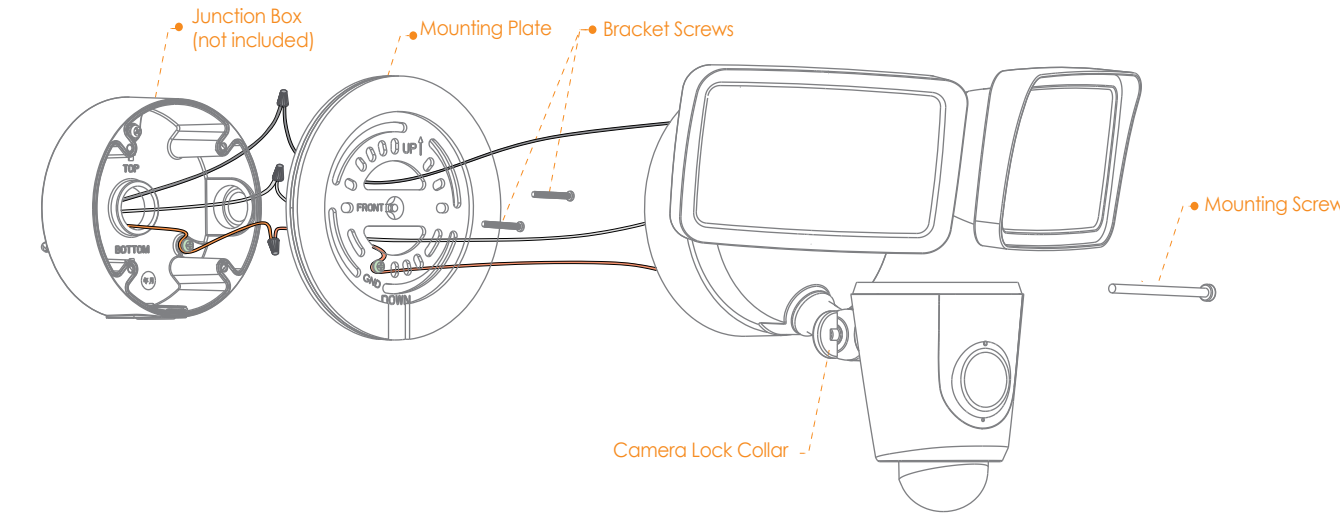

Application

When mounted at 3 m (10 feet) off the ground, with the PIR lens parallel to the ground, the motion detector is optimized to detect human-sized objects at up to 10 m (33 feet).

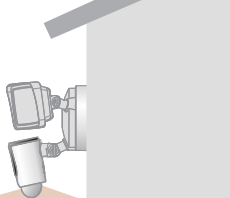

Camera Introduction

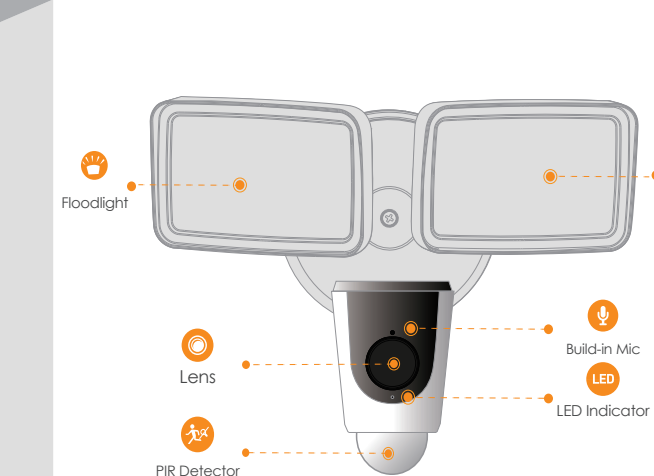

Note: Press and hold the reset button for 10 s to reset the camera.

The pattern of the LED indicator is included in the following table.

LED Indicator Status	Device Status
Off	<ul style="list-style-type: none">Powered off/LED turned offRebooting after reset
Red light on	<ul style="list-style-type: none">BootingDevice malfunction
Green light flashing	Waiting for network
Green light on	Operating properly
Red light flashing	Network connection failed
Green and Red light flashing alternately	Firmware updating