

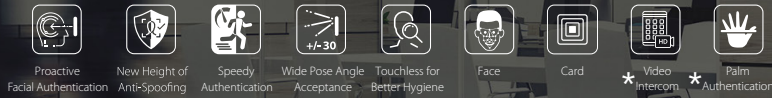

SpeedFace-V5L Series

Linux-Based Hybrid-Biometric Access Control & Time and Attendance Terminal with Full Spectrum of Authentication Options



Compatible with **ZKBio CVAcess**

Compatible with **ZKBio Zlink***



SpeedFace V5L

SpeedFace-V5L-RFID

SpeedFace-V5L[QR]

The SpeedFace-V5L Series employs intelligent engineering facial authentication algorithms and cutting-edge computer vision technology. It supports different versions of SpeedFace-V5L with large capacity and speedy authentication to satisfy your needs. SpeedFace-V5L[QR] comes with a QR code module to support Dynamic QR code via ZKBio CVAcess Mobile APP, while the SpeedFace-V5L-RFID standard ID card verification function.

SpeedFace-V5L Series uses touchless authentication technology and can identify individuals even when wearing masks, making it a hygienic option. Additionally, it has an advanced anti-spoofing algorithm that can detect fake photos and videos.

* SpeedFace-V5L Series features a video intercom function with SIP protocol (Version 2.0) for compatible with video intercom indoor unit and supports ONVIF protocol to connect to ONVIF NVR for Video surveillance and recording. Moreover, it is compatible with ZKBio Zlink Mobile APP & ZKBio Zlink-Web when switching to BEST protocol.

Features

- Visible light facial authentication technology
- Full spectrum of authentication methods: support Facial authentication / Fingerprint authentication / Scramble QR Code / Palm authentication (Optional) / Card / Password (Virtual Keypad)
- Enlarged Capacity: 10,000 (facial) / 10,000 (fingerprint) / 3,000 (palm)* / 10,000 (RFID card) / 200,000 transactions
- * HD video door phone via SIP protocol with ZKTeco SIP Video intercom indoor monitor and supports ONVIF Protocol
- Available card modules: 125 kHz ID card / 13.56MHz IC card / 125 kHz ID card & 13.56MHz IC Multi-tech card module(optional)
- Mask detection; facial authentication available with masked individual
- Support AC push and convert to TA push

* Note: Facial authentication for masked individuals will increase FAR.

Note: Palm authentication is for indoor use only.

Note: Features marked with (*) or indicated as "Optional" refer to non-standard functions and may not be available on all models.

Specifications

Model	SpeedFace-V5L	SpeedFace-V5L-RFID	SpeedFace-V5L[QR]
Order ID	AC01-SP14H-P47	AC01-SP12H-P47	AC01-SP15H-P47
Display	5"@ ISP Color LCD Screen (720*1280)		
Camera	Binocular Camera @ 2MP WDR		
Operation System	Linux		
Hardware	CPU: Quad Core A55 @1.2GHz RAM: 1GB; ROM: 8GB Supplement Light: Yes Virtual Keypad: 16 Keys Fingerprint Sensor: Z-ID Casing Color: Metallic silver	CPU: Quad Core A55 @1.2GHz RAM: 1GB; ROM: 8GB Supplement Light: Yes Virtual Keypad: 16 Keys Casing Color: Metallic silver	CPU: Quad Core A55 @1.2GHz RAM: 1GB; ROM: 8GB Supplement Light: Yes Physical Keypad: 16 Keys Casing Color: Metallic silver
Authentication Method	Face / Fingerprint / Palm (Optional) / Card / Password (Virtual Keypad)	Face / Palm (Optional) / Card / Password (Virtual Keypad)	Face / Palm (Optional) / Card / Password (Virtual Keypad)
Fingerprint Template Capacity	10,000 (1:N)	/	/
Face Template Capacity	10,000 (1:N)		
* Palm Template Capacity	3,000 (1:N) (Optional)		
Card Capacity	10,000 (1:N)		
User Capacity	10,000 (1:N)		
Transaction Capacity	200,000 (1:N)		
Max. User Password Length	8 Digits		
Biometric Authentication Speed	less than 0.5 sec (Fingerprint) less than 0.35 sec (Facial authentication) less than 0.35 Sec (Palm)	less than 0.35 sec (Facial authentication) less than 0.35 Sec (Palm)	less than 0.35 sec (Facial authentication) less than 0.35 Sec (Palm)
Touchless Biometric Authentication Distance	30cm to 170cm (Facial authentication) 15cm to 40cm (Palm authentication)		
False Acceptance Rate (FAR) %	≤0.01% (Facial authentication) ≤0.0001% (Fingerprint) ≤ 0.01% (Palm)	≤0.01% (Facial authentication) ≤ 0.01% (Palm)	
False Rejection Rate (FRR) %	≤0.02% (Facial authentication) ≤ 0.01% (Fingerprint) ≤ 0.17% (Palm)	≤0.02% (Facial authentication) ≤ 0.17% (Palm)	
Biometric Algorithm	ZKFace V3.6 ZKFingerprint V13.0 (Standard) / V10.0 (Optional) ZKPalmVein V20.1(Optional)	ZKFace V3.6 ZKPalmVein V20.1(Optional)	
Card Type	ID Card@125kHz (Optional) IC Card@13.56 MHz (Optional) Optional Multi-Tech Module: Module1: ID & IC & DESFire EV1 / EV2 & Felica (125 kHz & 13.56 MHz Dual Frequency) Module 2: ID & IC & DESFire EV1/EV2 & FeliCa & HID Prox & HID iClass (125 kHz & 13.56 MHz Dual Frequency)	ID Card@125kHz (Standard) IC Card@13.56 MHz (Optional) Optional Multi-Tech Module: Module1: ID & IC & DESFire EV1 / EV2 & Felica (125 kHz & 13.56 MHz Dual Frequency) Module 2: ID & IC & DESFire EV1/EV2 & FeliCa & HID Prox & HID iClass (125 kHz & 13.56 MHz Dual Frequency)	
QR Code	Dynamic QR codes on the ZKBio CVAccess mobile application (Optional) (Via Face Camera)		Dynamic QR codes on the ZKBio CVAccess mobile application (Standard) (Via QR Module)

Note: Features marked with (*) or indicated as "Optional" refer to non-standard functions and may not be available on all models.

Communication	TCP/IP*1 Wi-Fi (IEEE802.1b/g/n/a/ac/ax) @ 2.4 GHz / 5 GHz (Optional) Wiegand (Input & Output)*1 RS485: ZKTeco RS485*1* Aux Inputs *1, Aux Outputs *1, Electric Lock*1, Door Sensor*1, Exit Button*1, Alarm*1
Standard Functions	ADMS, DST, Photo Capture, Event Photo Capture, Up to 14-digit User ID, Access Levels, Groups, Holidays, Anti-Passback, Record Query, Tamper Switch Alarm, Multiple Verification Methods, T9 Keyboard (Input), AC Push and TA Push Protocol Switch, HTTPs / SSH Backend Access, Mask Detection
Optional Functions	Video Door Phone: SIP Client (Version2.0), ONVIF (Compatible with Profile S, Profile T, Profile G, Profile C, Profile Q & Profile A), Wi-Fi, Webserver
* Video Intercom	Video Intercom(ZKTeco Private Protocol via TCP/IP) Support Devices: Standalone Terminal: SpeedFace-V5L(Only ZAM230 Platform) Indoor Monitor: VT07-B01, VT07-B01-W Video Intercom (Standard SIP Protocol) Support Devices: Standalone Terminal: SpeedFace-V5L(Only ZAM230 Platform) Indoor Monitor: VT07-B22L, VT07-B26L-W Software: ZKBio CVAccess, BioTalk Pro Mobile App: ZKBio Zlink, ZKBio Zexus
Access Control Interface	RS485 (DM10 Controller 1 Door Expansion* / RS485 Card Reader / Biometric Reader)
Power Supply	DC 12V 3A
Operating Temperature	-10°C to 45°C (14°F to 113°F)
Operating Humidity	10% to 90% RH (Non-condensing)
Dimensions	202.93mm * 91.93mm * 21.5mm (L * W * H)
Gross Weight	1.3 Kg
Net Weight	0.6 Kg
Supported Software	On-Premise Software: ZKBio CVAccess (AC PUSH) & ZKBio Time (TA PUSH) * Cloud-based Software: ZKBio Zlink (Supports Web Portal & Mobile App)
Installation	Wall-mount (Compatible with Asian Gang-box / Single Gang-Box)
Certifications	ISO14001, ISO9001, CE, FCC

Configuration

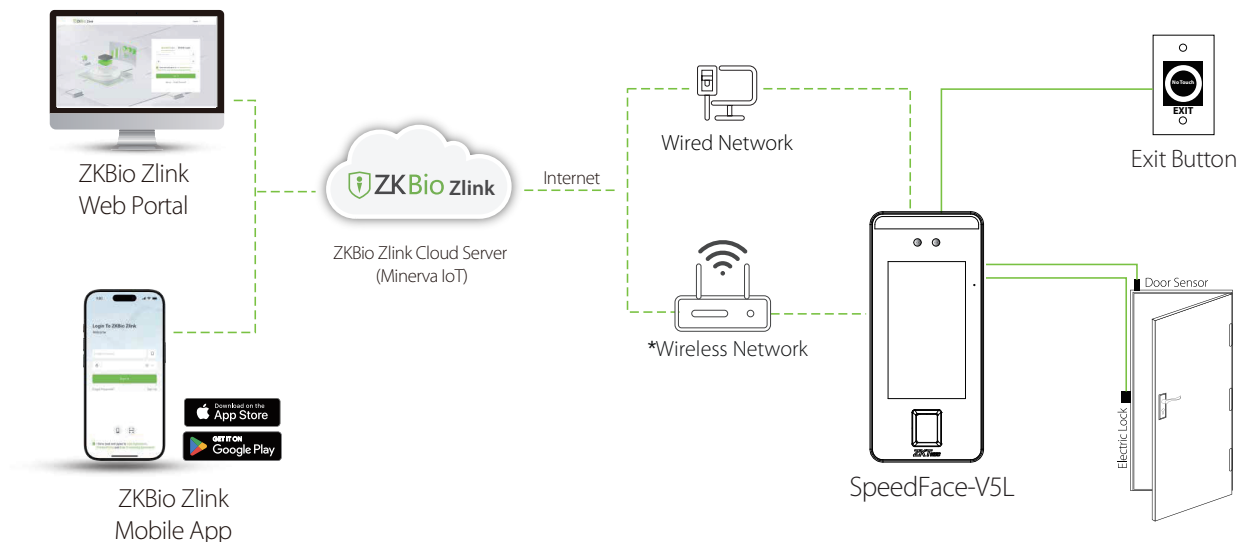

***BEST Protocol**

Note: Features marked with (*) or indicated as "Optional" refer to non-standard functions and may not be available on all models.

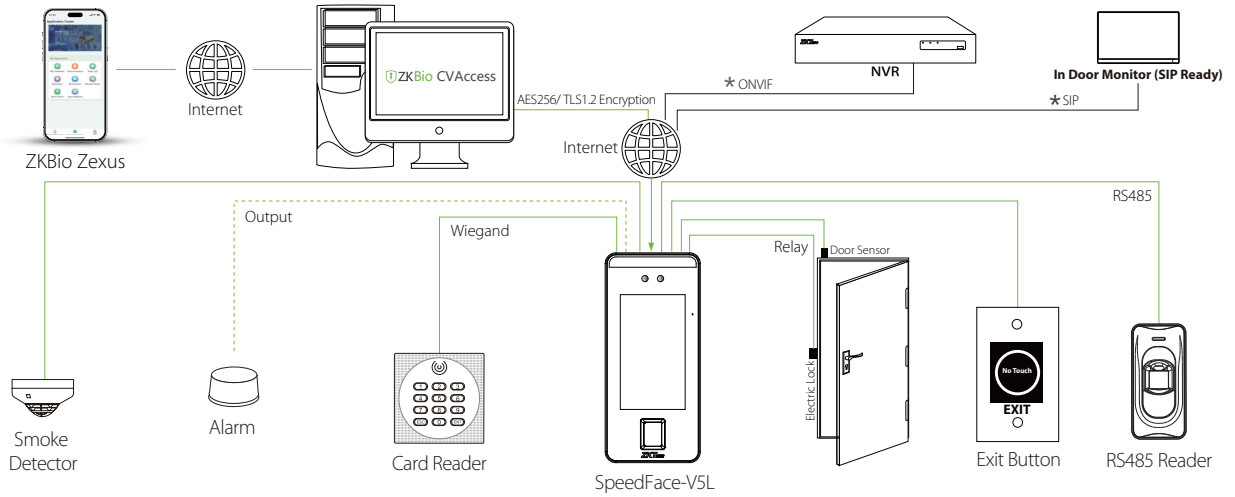

PUSH Protocol

Dimensions (mm)

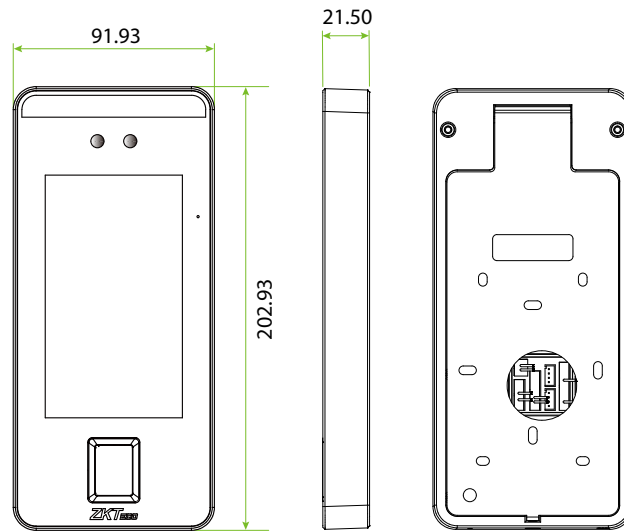

SpeedFace-V5L

Note: Features marked with (*) or indicated as "Optional" refer to non-standard functions and may not be available on all models.

