



# Setup Guide

# Setup Guide

## Solar-Powered Security Camera Kit

Welcome to the setup guide.

To ensure equal access for all users, we offer this accessible setup guide. This guide is designed to meet accessibility needs, enabling a successful setup. It will introduce the appearance of your camera and solar panel, including its ports, buttons and labels, and then guide you through connecting the setup process.

### Step 1. Know about your camera

In this section, we will describe the camera's appearance, including its ports, buttons, and labels.

1. You can find your camera in the package.

2. Next, place your camera on a horizontal surface, such as on a shelf or desktop. To ensure the camera is placed correctly, you should position it with the camera lens facing forward.

3. After positioning your camera correctly, we will introduce the ports, buttons and labels on your device in a certain order.

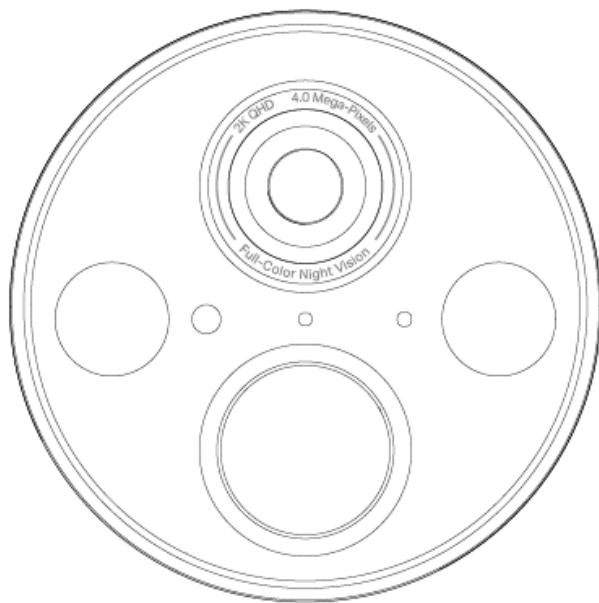

**Lens:** Located at the top front center for capturing things within its view.

**Status LED:** Directly below the lens. It shows your camera status. You can check the camera status in the Tapo app.

**Light Sensor:** It is on the left of the Status LED. For detecting if the environment is dark or bright.

**Microphone:** It is on the right of the Status LED. For capturing your voice.

**Spotlights:** On the far left and far right below the lens. Turns on in darkness for night vision to offer color images.

**Motion Sensor:** Below the Status LED. It is a round area for detecting motion.

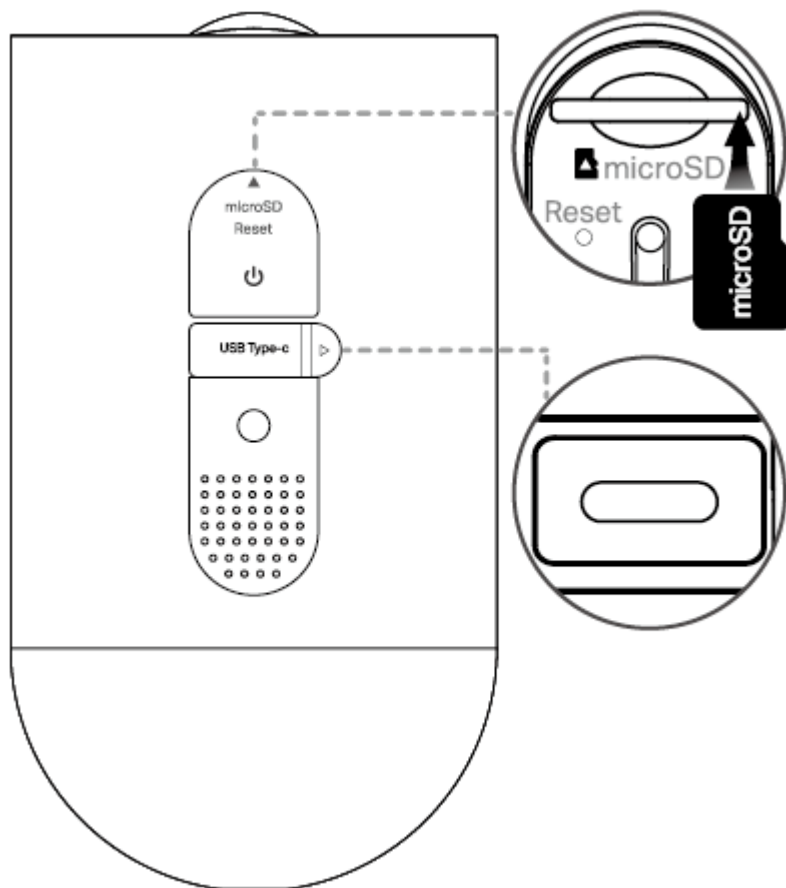

Turn to the side of the camera. The silicone part consists of two parts.

Open the first silicone cover, you can find a microSD card slot, a reset hole, and a power button.

**microSD Card Slot:** On the top. Insert a microSD card with the notch.

**Reset:** A tiny hole below the microSD card slot. Use a pin to press and hold for 5s to reset Wi-Fi while keep other settings; press and hold for 10s to reset to factory settings. You will hear voice prompts when reset successfully.

**Power Button:** A tiny hole below the microSD card slot next to the Reset hole. Press and hold the button for about 3 seconds to turn on/off the camera. You will hear a sound when turning on/off.

For the second silicon part, open the cover and you can find a charging port.

**USB Type-C Charging Port:** For USB charging with the provided cable.

Below the silicone parts, it is a mounting hole and a speaker.

**Mounting Hole:** For installing the bracket to secure the camera.

**Speaker:** Small perforated area, feels like tiny holes. For two-way audio and camera voice prompts.

**Product "Label":** The product label is through laser engraving next to the speaker.

## **Step 2. Know about solar panel**

In this section, we will describe the solar panel's appearance.

1. You can find a large rectangular flat panel and a mounting bracket in the package.
2. The back of the solar panel is where the power cable comes out. You can connect this cable to the camera USB port to charge the camera. The notch next to the power cable is where the bracket snaps into place to secure the solar panel.
3. The front side is made of high-efficiency solar cells, facing the sun to get most sunlight.

## **Step 3. Set up**

1. Get the Tapo app from the App Store or Google Play, then log in.



2. Press and hold the Power button for about 3 seconds to turn on the camera. You will hear a sound when turning on.

3. Tap the + button in the app and select your camera model. Follow app instructions to complete setup.

If you need help, please visit <https://www.tapo.com/support/> for technical support, the user guide, FAQs, warranty & more.

For details on Tapo app accessibility, please check [Accessibility Support](#).

## Safety Information

### For Solar Panel:

- Keep the device away from fire or hot environments. DO NOT immerse in water or any other liquid.
- Do not attempt to disassemble, repair, or modify the device. If you need service, please contact us.

### For Battery Camera

- Do not use damaged charger or USB cable to charge the device.
- Do not use any other chargers than those recommended.
- Do not use the device where wireless devices are not allowed.
- Adapter shall be easily accessible.
- Use only power supplies which are provided by manufacturer and in the original packing of this product. If you have any questions, please don't hesitate to contact us.
- Keep the device away from fire or hot environments. DO NOT immerse in water or any other liquid.
- Do not disassemble, repair or modify the product.
- Do not place near automatically controlled devices such as fire alarms. Radio waves emitted from this product may cause such devices to malfunction resulting in an accident.
- Observe restrictions on using wireless products in fuel depots, chemical plants or when blasting operations are in progress.
- Do not use liquid to clean the product. Only use a dry cloth.
- Never put metal objects inside the product. If a metal object enters the product turn off the circuit breaker and contact an authorised electrician.
- This product is not intended to be used when providing medical care. Consult the manufacturer of any personal medical devices, such as pacemakers or hearing aids to determine if they are adequately shielded from external RF (radio frequency) energy.
- Do not use this product in health care facilities. Hospitals or health care facilities may be using equipment that could be sensitive to external RF energy.
- Do not place heavy objects on top of the product.
- When you leave the product unused for a long time unplug the product from the power outlet.
- This product may interfere with other electronic products such as TV, radios, personal computers, phones or other wireless devices.
- Operating Temperature: -20°C ~ 45°C (-4°F ~ 113°F)
- Adapter should be used indoors where the ambient temperature is lower than or equal to 40°C.
- This equipment can be powered only by equipments that comply with Power Source Class 2 ( PS2) or Limited Power Source(LPS) defined in the standard of IEC 62368-1.

**CAUTION!**

Avoid replacement of a battery with an incorrect type that can defeat a safeguard.

Avoid disposal of a battery into fire or a hot oven, or mechanically crushing or cutting of a battery, that can result in an explosion.

Do not leave a battery in an extremely high temperature surrounding environment that can result in an explosion or the leakage of flammable liquid or gas; Do not leave a battery subjected to extremely low air pressure that may result in an explosion or the leakage of flammable liquid or gas.

Please read and follow the above safety information when operating the device. We cannot guarantee that no accidents or damage will occur due to improper use of the device. Please use this product with care and operate at your own risk.