

DH-MPT230

Dahua Body Camera



Series Overview

With its ergonomic design, the Body Camera is both easy to carry and convenient to use. By just the press of a button, it can take pictures, and record videos and audios while an event is occurring, and directly upload recording files to the Data Collection Station or platform. Through the 4G network, it can also cooperate with the platform to perform functions such as live video, group talk and alarm event handling.

Functions

Wide-angle View

With its 146° ultra-wide-angle lens, the device offers a broader range for capturing images.

OSD Information

The OSD displays the time, user, device, task and GPS information. Two pieces of OSD information can be customized.

Capture the Truth in Any Situation

With a simple press of a button, the device effortlessly records videos and audios, and captures images to preserve crucial information of any given event.

Interaction with the Control Center

When working with the Dahua platform, the device can send alarm and GPS information and perform PTT voice talk through one button, making it convenient for officers to communicate with their headquarters in real time.

- Comes with an 8-core 2.0 GHz high-performance processor and the Android 11.0 system.
- Built-in 64 GB internal storage and supports expanding storage to 256 GB.
- 2.4-inch capacitive touchscreen
- Supports dual streaming and H.265/H.264 video compression.
- Video resolution up to 2560 × 1440 and image resolution up to 49 MP (9408 × 5292).
- Includes an LED light and IR light for clearer videos and images in dark locations.
- The IR light can be automatically or manually switched on, making outlines within 10 meters clearly visible.
- Advanced EIS algorithms that allow the device to take clear and stable images when it is in motion.
- Advanced AES-256 encryption technology for video recording.
- Supports self-adaptive network streaming, and adjusting the stream according to the network conditions to ensure smooth video preview.
- Offers AI functions such as face detection and license plate recognition.
- Supports 2G, 3G and 4G cellular networks, Wi-Fi, Bluetooth and using GPS and GLONASS positioning.
- Supports the automatic calibration of the time through the platform, satellite, or cellular network.
- It is IP68 rated, and received rigorous testing with four 2-meter drop tests.

Emergency Handling

In the event of an emergency, pressing the SOS button will promptly send alarms to the platform. The emergency can also be conveniently reported on directly from the scene using the audio talk function. After the emergency is received, the platform will swiftly dispatch necessary personnel to the GPS location displayed on the map, prioritizing the safety of individuals on-site.

Technical Specification

System

Operating System	Android 11.0
RAM	4 GB
Storage Capacity	64 GB

Screen

Screen Size	2.4"
Brightness	450 cd/m ²
Contrast	800:1
Resolution	240 (H) × 320 (V)
Screen Type	IPS
Touchscreen Type	Capacitive touchscreen

Camera

Max. Aperture	Rear camera: F2.0 Front camera: F2.2
Field of View	Rear camera: H: 125°; D: 146° Front camera: H: 80°; D: 82°
Focal Length	Rear camera: 2.45 mm Front camera: 2.23 mm
Focus Control	Rear camera: Fixed focal Front camera: Fixed focal
Image Stabilization	Electronic Image Stabilization (EIS)

Audio/Video

Video Compression	H.265;H.264
Video Format	DAV;MP4
Video Resolution/Frame Rate	Rear camera: 2560 × 1440@30/25/20/15 fps; 1920 × 1080@30/25/20/15 fps; 1280 × 720@30/25/20/15 fps; 864 × 480@30/25/20/15 fps Front camera: 1080 × 1920@30/25/20/15 fps; 720 × 1280@30/25/20/15 fps; 480 × 864@30/25/20/15 fps
Video Bit Rate	Main stream: 2560 × 1440@30/25/20/15 fps: 4M/6M/8Mbps 1920 × 1080@30/25/20/15 fps: 2M/4M/6Mbps 1280 × 720@30/25/20/15 fps: 1M/2M/3Mbps 864 × 480@30/25/20/15 fps: 512K/1M/2Mbps Stream acquisition : 1920 × 1080@30/25/20/15 fps: 1.5M/2M/4Mbps 1280 × 720@30/25/20/15 fps: 1.5M/2M/3Mbps 864 × 480@30/25/20/15 fps: 768K/1M/2Mbps
Image Resolution	Supports up to 49 MP (9408 × 5292), and 34 MP, 16 MP, 4 MP and 0.4 MP can be set.
Image Encoding Format	JPG
Continuous Shots	Supports taking 2, 3, 5, and 10 continuous snapshots.
Video Packaging Time	Can be set as 5, 10, 20 or 30 minutes.
Pre-Record/Post-Record	Pre-recording time reaches 120 sec and post-recording reaches 600 sec.
Distortion Correction	Yes

IR Switching Mode	Supports the manual and auto modes (it is manual by default).
Max. IR Distance	Sees faces up to 5 m away and outlines up to 10 m away.
Day/Night Illumination	When the lighting falls below 1.8 lux, the device switches to B/W mode. When the lighting is above 12 lux, the device switches to Color mode.
Min. Illumination	0.0001 lux (B/W)
White Balance	Auto
LED Flashing Light	1
Audio Compression	G711a
Audio Sampling	8 kHz, 16 bit
Audio Format	WAV; DAV
Key Mark	Yes

Wireless Parameters

Wireless Network Frequency Band	GSM:850/900/1800/1900; WCDMA:850/900/1900/2100; EVDO: 800; TDD-LTE:B38/B39/B40/B41; FDD-LTE:B1/B2/B3/B4/B5/B7/B8/B20/B28
Wi-Fi	2.4 GHz/5 GHz, 802.11 a/b/g/n/ac
Bluetooth	Bluetooth 5.0
NFC	13.56 MHz; NFC Forum Type 1/2/3/4/5 tags; ISO/EC 15693
Positioning	GPS; GLONASS; Galileo Positioning accuracy: In outdoor locations with few obstacles, the accuracy has a margin of error of 15 meters.

Function

Cyber Security	Configuration encryption;Account lockout;Security logs;IP/MAC filtering;AES256 video encryption;AES256 file encryption
Voice Prompt	Supports voice broadcast prompts.
OSD Overlay	Time; user ID; device ID; latitude and longitude; task ID; custom 1; custom 2
Network Protocol	Private protocol (auto registration); RTSP; FTP
Shortcut Function	With the press of a button, it records videos and audios, takes pictures, turns on IR, sends alarm, performs PTT voice talk and flags files.
Face Detection	Yes
ANPR	Yes

Port

USB	1 × Type-C USB 2.0 port
External Port	6-Pin metal port (connects through the Pogo Pin connector)

General

SIM Card Slot	2 × Nano SIM card slot
Microphone	2

Speaker	1, 1.5 W power
Button	Power on/off; flag files; record videos; take pictures; PTT voice talk; record audios; SOS; Fn custom; turn on/off IR
Indicator Light	1, 3-Color light indicates status and charging status
Sensor	Gyroscope; gravity acceleration sensor; photosensitive sensor; geomagnetic sensor
Battery Capacity	Large battery: 3200 mAh (4.35 V) Small battery: 50 mAh (4.35 V); it supports uninterrupted battery replacement for up to 5 minutes.
Battery Detachability	Yes
Charging	5 VDC, 2 A
Operating Time	Lasts up to 10 hours (when in airplane mode with recording set as 1080p@30 fps, and all the lights and screen are turned off)
Standby Time	168 hours
Charging Time	3 hours
Protection	The bare machine is IP68 rated, and received rigorous testing with four 2-meter drop tests.
Operating Temperature	−20 °C to +55 °C (−4 °F to +158 °F)
Operating Humidity	<95% (RH), non-condensing
Net Weight	183 g (0.40 lb) (battery included, without back clip)
Gross Weight	560 g (1.23 lb) (package included)
Product Dimensions	106 mm × 64 mm × 34 mm (4.17" × 2.52" × 1.34") (L × W × H)
Packaging Dimensions	167 mm × 138 mm × 64 mm (6.57" × 5.43" × 2.52") (L × W × H)
Accessory	Type-C USB charging cable; 5 V 2 A power adapter; clip
Certifications	CE

Ordering Information		
Type	Model	Description
Body Camera	DH-MPT230	Dahua Body Camera

Dimensions (mm[inch])

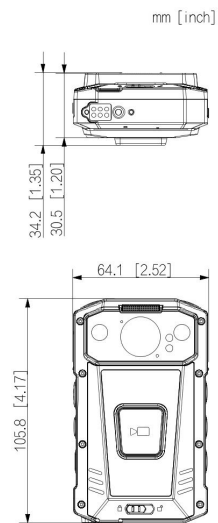

Panels

