

InBioPC Series

Professional Primary Controller

Compatible with

 **ZKBio CVSecurity**



InBioPC-400



InBioPC-800

The **InBioPC** Main Controller is the pinnacle of access control technology, offering seamless integration with DE-10 Door Units and supporting up to 4/8 access points. Engineered for high-speed TCP/IP communication, it ensures efficient and reliable data transfer. The onboard webserver, accessible via Wi-Fi, simplifies system configuration, providing unparalleled ease of use. Compliant with power over ethernet (PoE IEEE802.3 and PSE@30W) standards, the InBioPC can power up to 4/8 DE-10 Door Units, delivering both performance and convenience.

This advanced controller boasts a suite of sophisticated access control functions and supports dynamic QR code generation through the ZKBio CVSecurity Mobile Applications, enhancing security and user experience. With support for InBioPC offers versatile authentication methods to meet diverse security needs. Its compatibility with the ZKTeco A&C push protocol ensures seamless communication with ZKBio CVSecurity software.

Operating within a wide voltage input range of AC 100V~240V, the InBioPC is designed for global deployment. It incorporates high-security data encryption methods, including HTTP / HTTPS, SSH, AES256, and TLS 2.0, safeguarding sensitive information. Supporting both Wiegand readers (formats: W26 / W34 / W66) and RS485 card readers (protocol: ZKTeco RS-485), it provides flexible connectivity options.

Furthermore, the InBioPC is designed in a standard 1U server rack size, ensuring compatibility with standard server rack installations. This makes it an ideal choice for organizations looking to deploy a robust, scalable, and secure access control solution.

Features

- Seamlessly integrates with DE-10 Door Units, supporting up to 4/8 access points.
- Supports high-speed TCP/IP communication for efficient data transfer.
- An embedded onboard webserver is available for system configuration and is accessible via Wi-Fi.
- Complies with IEEE 802.3 at PoE and PSE@30W standards to power up to 4/8 DE-10 Door Units.
- Equipped with advanced access control functions for enhanced security.
- Supports dynamic QR code generation with ZKBio CVSecurity Mobile Applications.
- Supports multiple credential options, including biometrics, RFID, and password.
- Compatible with the A&C push protocol.
- Operates with a wide voltage input range of AC 100V~240V.
- Supports high-security data encryption methods such as HTTP / HTTPS, SSH, AES256, and TLS 2.0.
- Supports Wiegand readers (formats: W26 / W34 / W66) and RS485 card readers (protocol: ZKTeco RS-485)
- Designed in standard 1U server rack size to be compatible with standard server rack installation.

Specifications

Model	InBioPC-400	InBioPC-800
Display	NA	
Onboard Visual Indicator	POWER (RED): ON - Power Normal, OFF - No Power; RUN (GREEN): Slow Flashing - Normal Use, Flashing - Host not connected, OFF - No Power; LAN (GREEN): Steady on - No data interaction, Flashing - Data in Interaction, OFF - Network Connection Abnormal; FIRE (RED): Flashing - In Fire Alarm, OFF - No Fire Alarm; AUX IN (RED): Flashing - In Alarm, OFF - No Alarm; DOOR (GREEN): Steady ON - Door Closed, Flashing - Door Open, OFF - Lock Offline;	
Operation System	Linux	
Hardware	CPU: Dual Core@1.0GHz RAM: 128MB; ROM: 256MB;	
Authentication method	Card / Password / Fingerprint / QR code	
Access Point Capacity	Onboard Access Point: 0 Max Access Point: 4 (with DE10 Door Unit)	Onboard Access Point: 0 Max Access Point: 8 (with DE10 Door Unit)
Reader Capacity	NA	
IO Expansion Board Capacity	NA	
Authentication method	Card / Password / Fingerprint / QR code	
Supported Primary Controller	NA	
Fingerprint Template Capacity	4,000 (1:N) (Standard)	
Card Capacity	40,000 (1:N) (Standard)	
QR Code Capacity	40,000 (QR Code and Dynamic QR Code)	

User Capacity	40,000	
Transaction Capacity	200,000 (Standard)	
Number of Inputs	1*AUX Inputs, 1*FIRE	
Number of Outputs	1*Form C Relay for Aux Output 1*Form C Relay for Alarm	
Supported Biometric Algorithm	ZKFingerprint V10.0	
Max. Card Length	Supports up to 66 bits Card Length	
QR Code	Dynamic QR codes on the ZKBio CVSecurity mobile application QR code	
Communication	TCP/IP*1 Wi-Fi (IEEE802.11b/g/n/, 1T1R @ 2.4 GHz) (Wi-Fi only for webserver access)	
Standard Functions	Webserver, Upto 14-digit User ID, Access Levels, Access Groups, Holidays, Anti-passback, Anti-tailgating, Linkage, Global Linkage, Multiple Verification Methods	
Optional Functions	NA	
Access Control Interface	NA	
Verification Speed	less than 0.3 sec (Fingerprint)	
Power Supply	Power Input: AC 100V~240V Power Output: POE (IEEE802.3at PSE@30W output) *4	Power Input: AC 100V~240V Power Output: POE (IEEE802.3at PSE@30W output) *8
Operating Temperature	0°C to 45°C	
Operating Humidity	20% to 80% RH (Non-condensing)	
Dimensions	440mm*180mm*45mm (L*W*H) (Standard 1U Server Rack Size)	440mm*180mm*45mm (L*W*H) (Standard 1U Server Rack Size)
Gross Weight	2.725Kg	2.825Kg
Net Weight	2.079Kg	2.179Kg
Supported Software	Software: ZKBio CVSecurity	
Installation	Supported Rack-mount (Compatible with Standard Server Rack) / Wall-mount / Desktop	
Enclosure (Optional)	NA	
Housing Material	SGCC	
Certifications	ISO14001, ISO9001, CE, FCC, RoHS	
Factory ID	AC02-CB604H-16	AC02-CB608H-16

Configuration

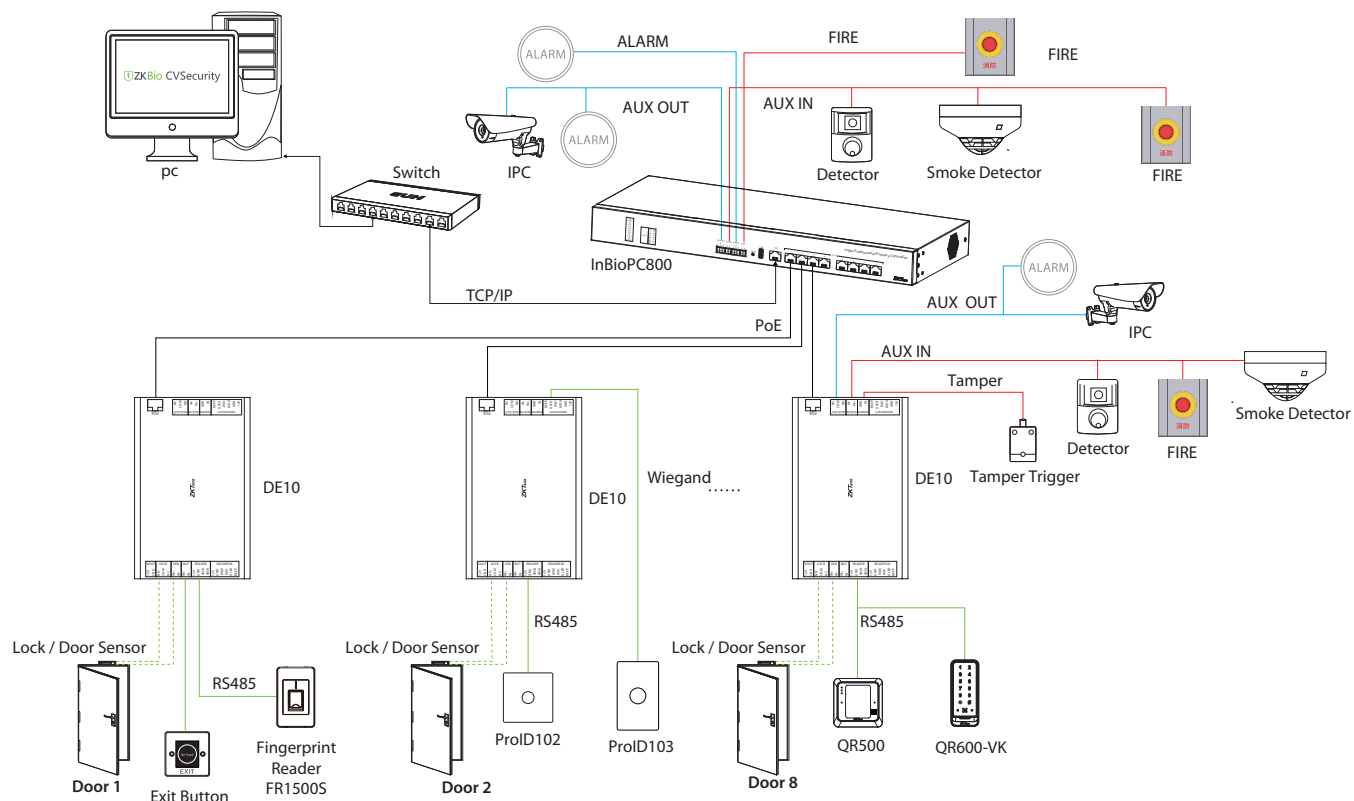

Dimensions (mm)

InBioPC-400

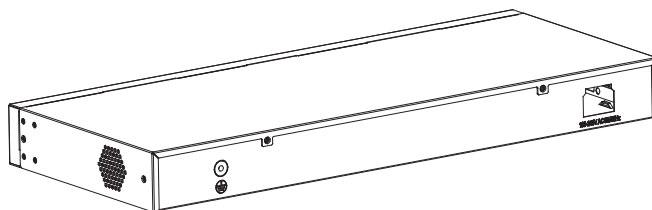
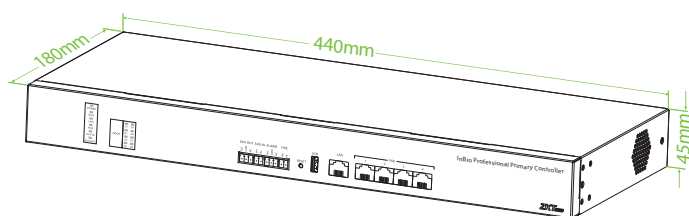

InBioPC-800

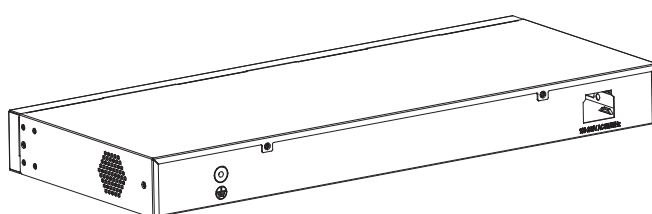
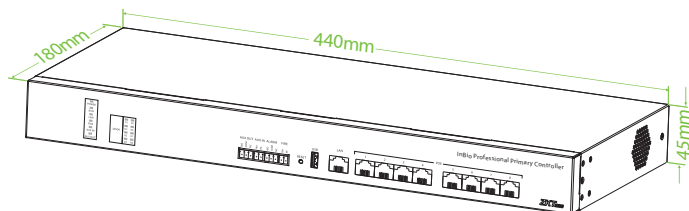

V1.1 02/26/2025