

RELA-SRV-1 Service Disconnect Switch RELA-ABT Abort Switch

RELA-SRV-1 Service Disconnect Switch

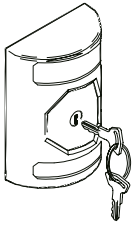

The RELA-SRV-1 Service Disconnect Switch is a key operated, manual switch station. It has both a normally closed and normally open dry contact relay. The switch is used to disconnect the releasing module for servicing.

Specifications

Voltage and rated average current
30 Vdc at 2 A, 250 Vdc at 1 A, 600 Vac at 3 A
Wire: 12 to 18 AWG
Dimensions: 3.25 x 4.87 x 3.87 in (82 x 124 x 98 mm) (W x H x D)

Installation instructions

To install the RELA-SRV-1:

1. Install the ground screw in the back of the back plate assembly.
2. Connect the lock assembly to the back plate. Pass the threaded portion of the lock assembly through the back plate and secure it with the lock nut. Make sure the keyhole is in a vertical position.
3. Push the relay holder onto the back of the lock assembly until it snaps into place. Make sure the releasing lever is pointed up.
4. Wire the relays. See the "Wiring diagram" for details.
5. Mount the back plate assembly to an existing single gang electrical box using the #6-32 screws provided.
6. Push the octagon-shaped switch housing piece onto the lock assembly with "Normal" at the top of the keyhole.
7. Connect the housing cover to the back plate assembly using the housing screw provided.

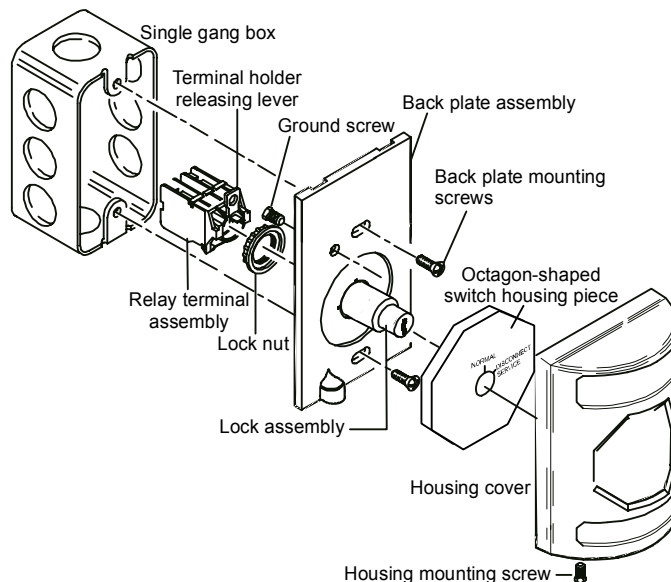

You may need to remove the relay holder or a relay to make wiring easier or you may need to install a different relay. Use the installation instructions that follow to perform these tasks.

To remove the relay holder:

1. Hold the housing firmly in one hand.

2. Apply downward pressure on the relay holder releasing lever.
3. Remove the relay holder and relays.

To remove a relay:

1. Insert a small screwdriver where the relay connects into the relay holder.
2. Pry upward to release the relay from the holder.

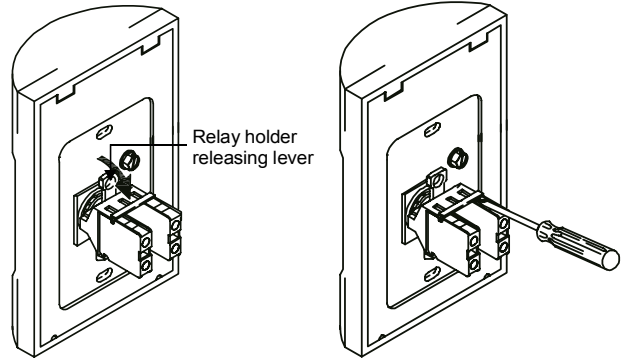

To install a relay:

1. Insert the bottom of the relay in the bottom slot on the relay holder.
2. Push upward to lock the relay in place in the top of the relay holder.

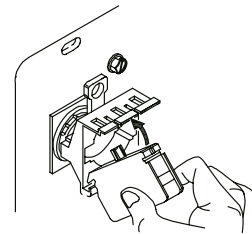

Wiring diagram

A normally closed (NC) and a normally open (NO) relay are provided. Wire the normally closed relay to the releasing module circuit. Wire the normally open relay to a supervisory module.

Note: UL requires that the supervisory module must be configured as a supervisory point and must report to the control panel.

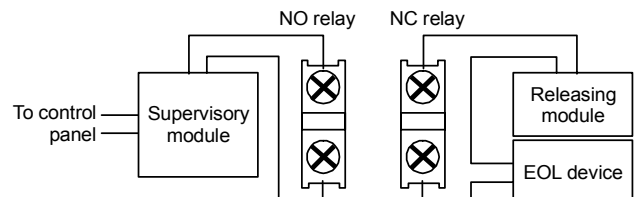

Operation

A key is required to operate the RELA-SRV-1. Two keys are provided with the switch. The key is used to activate and reset the switch. The key can be removed from the switch in either mode. The switch disconnects the releasing module for servicing. When activated, an open event and a supervisory event are indicated at the control panel.