

Fast guide

Horus

Version: 1.0

Date: June, 2019

1. View

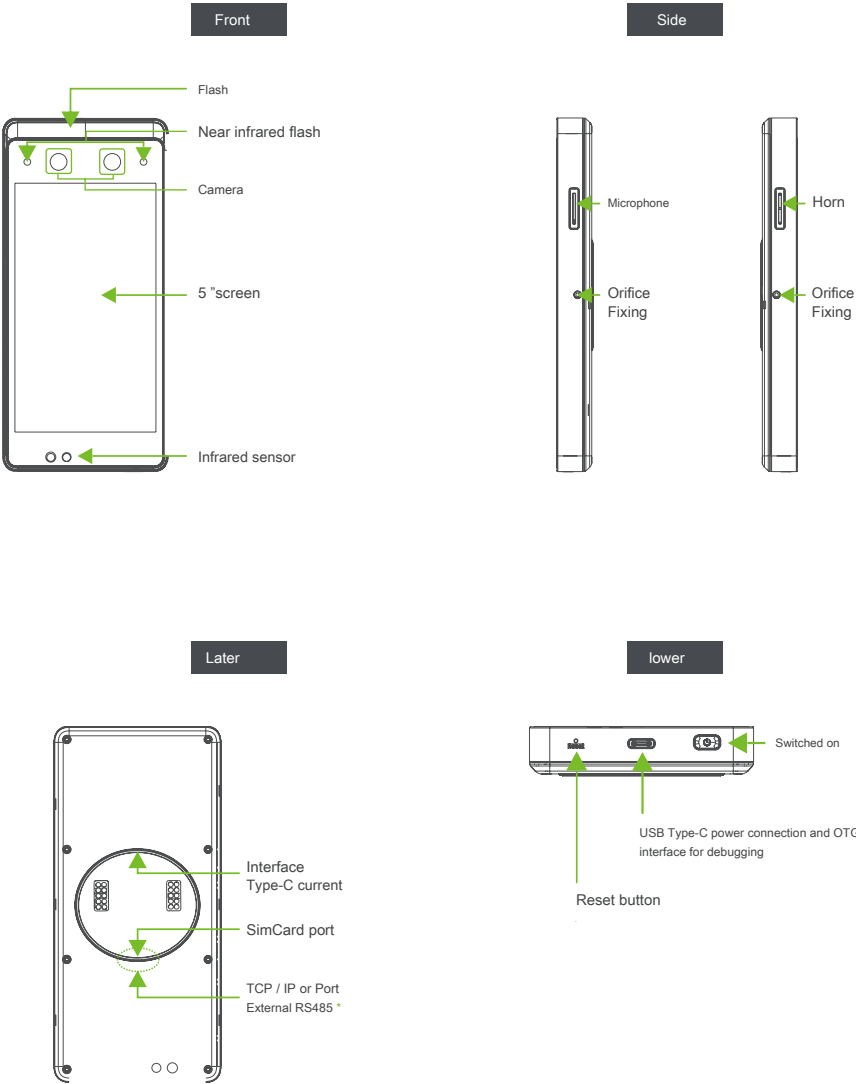

Note: This port can be extended to TCP / IP or RS485 communication, and can be connected to the DM10 module by RS485.

RFID & Fingerprint (Optional) *

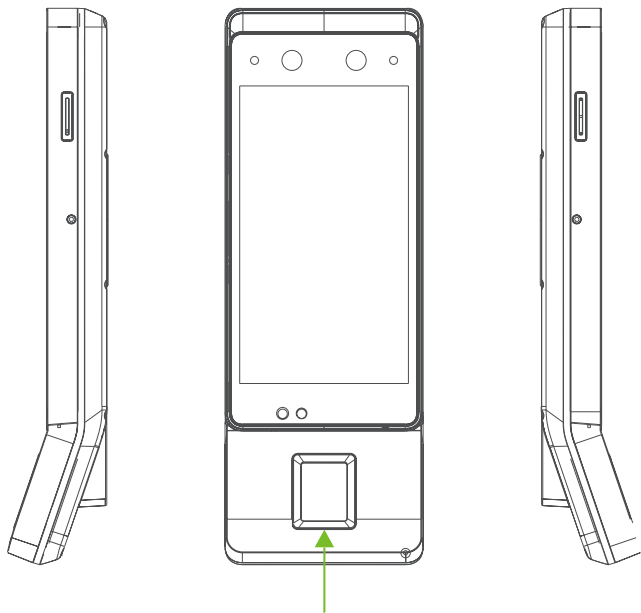

Fingerprint sensor, card reading area *

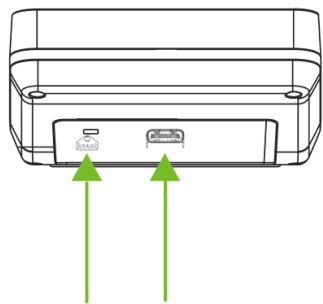

Reset button

Power USB Type-C and OTG interface for debugging

Note: Not all devices have the function marked with * , the actual product prevails.

2. Installation

to. Recommended location

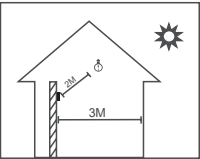

Install the device indoors at least 10 feet (3 m) from the window and 6.5 feet (2 m) from any light source. It is not recommended to install on windows or outdoors.

b. Not Recommended Locations

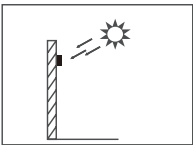

Direct sunlight outdoors

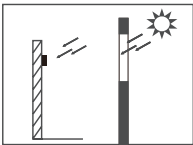

Direct sunlight in window

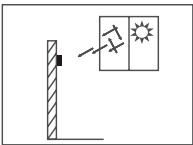

Indirect sunlight through window

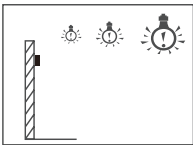

Very close to the light source

Installation Steps

to. Wall mount

Step 1

Attach the mounting template to the wall and drill holes according to the mounting paper.

Step 2

Fix the back plate to the wall with the mounting screws.

Step 3

Insert the device on the back plate.

Step 4

Use the security screw to secure the device to the back plate.

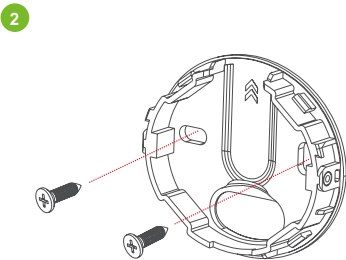
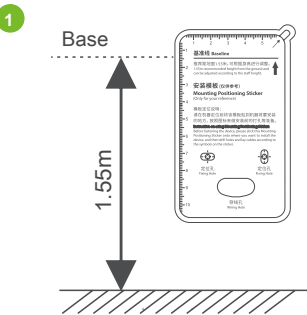

3

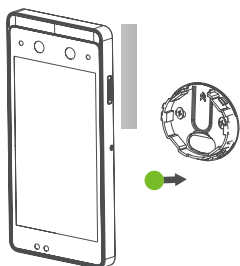

4

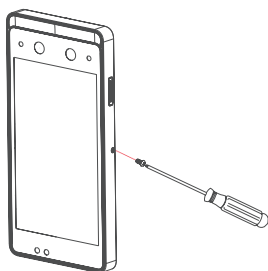

b. Mounting on the desktop stand

Step 1

Screw the back plate to the desk stand.

Step 2

Insert the back plate into the device, and use a security screw to secure the device to the back plate.

1

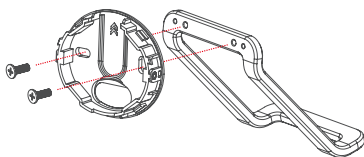

2

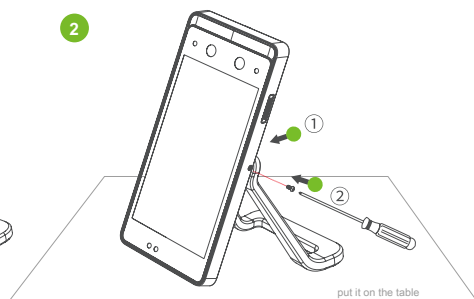

c. Glass door mounting

Step 1

Attach the double-sided tape to the rear panel. Then attach the back plate to the glass door.

Step 2

Attach the device to the back plate. Use a security screw to secure the device to the back plate.

1



Double-sided tape to the rear panel and

2

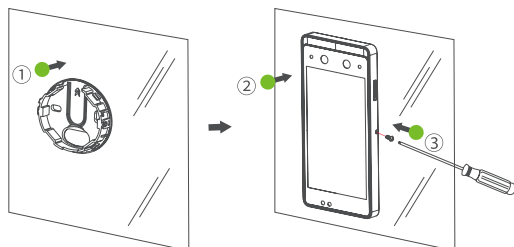

3. Source Connection

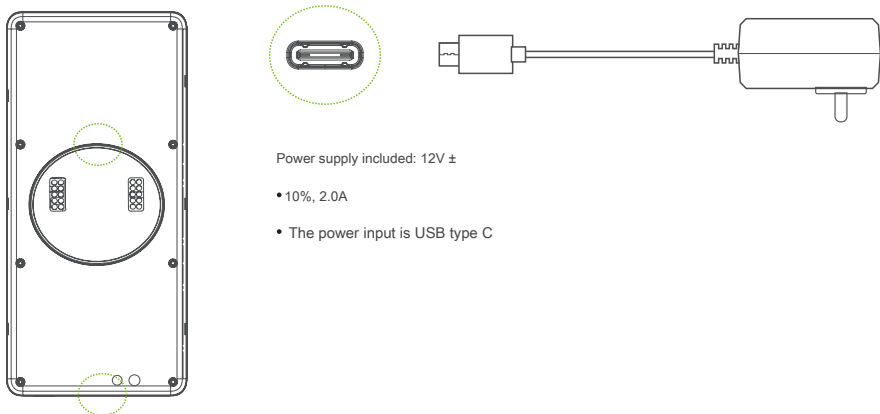

4. Operation Guide



User register

Register to device

Click > Employee> to register a new employee. Enter employee name, ID, register face, fingerprint, card (fingerprint and card are optional) and password.

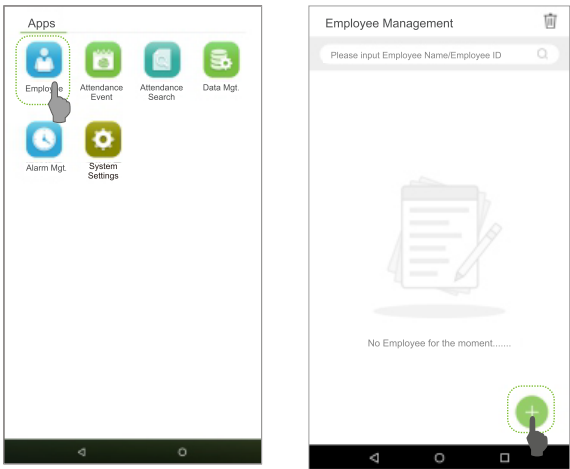

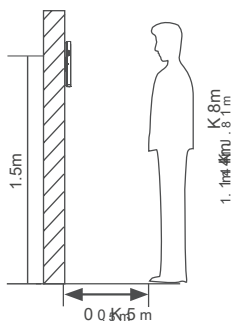

Note:

1. It is recommended to enroll different administrators.
2. It is recommended to roll a face at 0.5m distance for people of height 1.4 ~ 1.8m.

Register in Software (BioTime 8 / BioTime Pro)

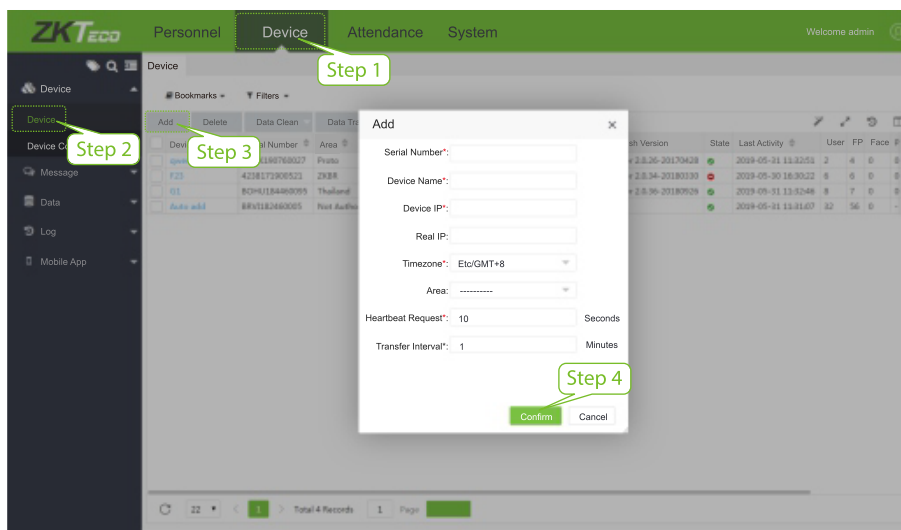

Set the server IP address and port (or domain name) on the device.

1. Click [Device]> [Device]> [Add] to add the device to the software. Data synchronization is automatic.



2. Click [Personnel]> [Employee]> [Employee]> [Add] to register users in the software.
3. Synchronize the software staff with the devices in the corresponding area automatically.

For more details, see the BioTime User Manual.

Note: The icons  or  on the standby interface indicate that the network connection or the server is abnormal. Check the network cable and network connection.

Face Registration on the phone

Once synced with BioTime, users can enroll their face through their own mobile phone. Allow users to independently enroll their face and sync the face template to other smart face recognition devices.

- 1. Choose [Personnel]> [Employee]> [Photo]> [QR Code] to enter the interface for obtaining the QR Code.
- 2. Scan the QR code through your phone to register the user's face.
- 3. The user can also manually enter the link `http://server_address:port/v1Register/` in his phone's browser. The following interface is displayed after a successful scan:

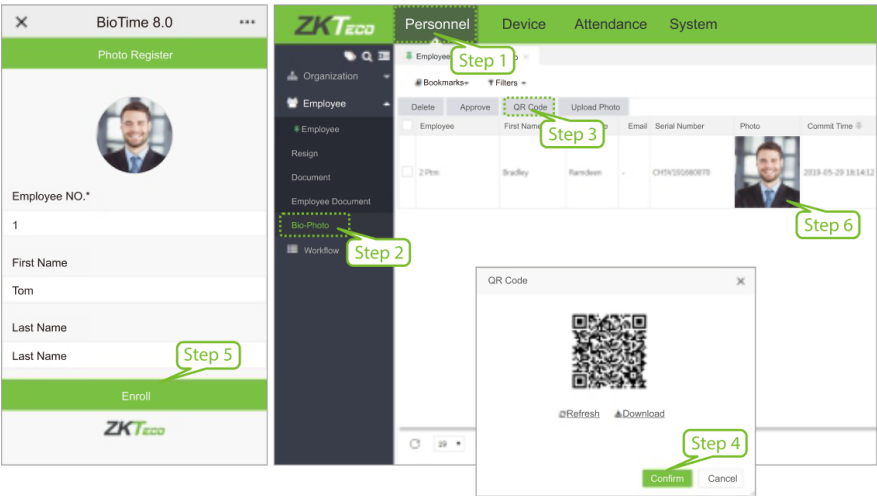

User Verification

The terminal can detect faces at a distance of 0.3m up to a maximum distance of 3m. The device automatically switches to the face verification interface once it detects a change in light in the environment. The verification result is shown as below:

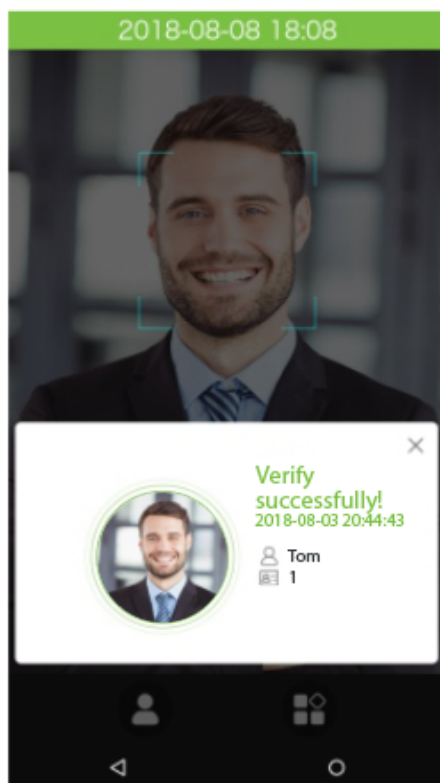

Verificación Exitosa

Reports generation

View Logs in the software

Click [Attendance]> [Report] in the software to generate attendance reports according to the rules of your organization.



www.zkteco.com



www.zktecolatinoamerica.com



Copyright © 2019, ZKTeco CO., LTD. All rights reserved. ZKTeco may, at any time and without prior notice, make changes or improvements to products and services or stop their production or marketing. The ZKTeco logo and trademark are the property of ZKTeco CO., LTD.