

Important Safety Notice

Please read below safety instructions carefully before installation and operation:

1. Do not expose this unit to rain, moisture and liquid.
2. Do not put any stuff on it.
3. Do not expose power lines on the unit surface to avoid the danger of electric shock.
4. Do not plug the device and connect cables when the device with power on to avoid cables damage.
5. Shut off power and make sure environment is safe before installation.

• Introduction

HDbitT HDMI wallplate extender is a wall plug type extender. It is made up of a sender and a receiver separately fixed on wall and can transmit up to 120 meters via single CAT6 cable. IR pass back is built in to allow controlling source device at the end of display.

• Features

1. Include a transmitter unit (TX) and a receiver unit (RX), working as a pair.
2. With 2.74inch×4.49inch wallplate US standard size.
(Wallplate size changeable).
3. Extend HDMI signal up to 120m over CAT6 cable.
4. The highest resolution supported is up to 1080p@60Hz.
5. Compatible with CAT5/5e/6 network cables.
6. Support interconnection with HDbitT network extenders.
7. Support IR pass back function
8. Plug and play.
9. Support AC100-240V 50/60Hz input

• Package Contents

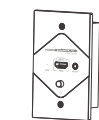

HDMI extender
Sender *1pcs

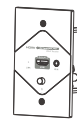

HDMI extender
Receiver*1pcs



User manual*1pcs



IR blaster
extension cable*1pcs

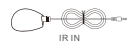

IR receiver
extension cable*1pcs



Screws*4pcs

• Installation Requirement

1. HDMI source device (DVD, PS3, Set top box, PC etc).
2. HDMI display device like SDTV, HDTV, and projector with HDMI port.
3. UTP/STP CAT5/5E/6 cable, follow standard IEEE-568B
1-Orange/white 2-Orange 3-Green/white
4-Blue 5-Blue/white 6-Green
7-Brown/white 8-Brown

Network cable length support between every connection:

CAT5 80m
CAT5E 100m
CAT6 120m

• Panel Description

1. HDMI Extender Sender

Front panel

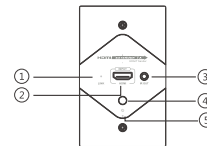

- ① Signal indicator
- ② HDMI signal input
- ③ IR signal output to connect with blaster extension cable

Rear panel

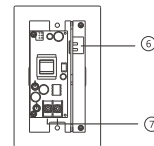

- ④ Power switch
- ⑤ Power indicator
- ⑥ RJ45 signal output
- ⑦ Power line interface

Note: Signal indicator : It lights on all the time with HDMI signal input, but flashes with no signal input.

2. HDMI Extender Receiver

Front panel

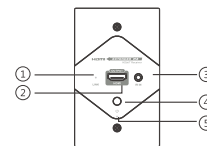

- ① Signal indicator
- ② HDMI signal output
- ③ IR signal input to connect with IR receiver extension cable

Rear panel

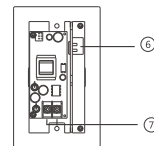

- ④ Power switch
- ⑤ Power indicator
- ⑥ RJ45 signal output
- ⑦ Power line interface

Note: signal indicator : It lights on all the time with HDMI signal transmission, but flashes with no signal transmission.

• Installation Procedure

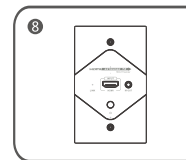
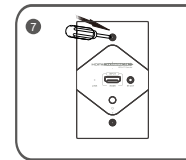
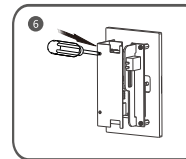
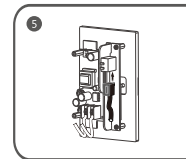
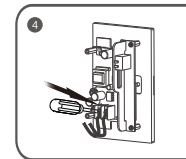
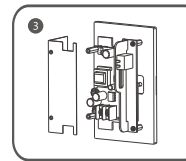
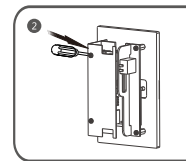
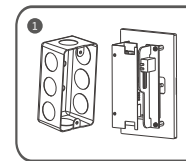

Note: please shut off power before installation

- ① Remove the extender wall plate from the back box(please refer to figure 1)
- ② Remove the extender insulating base.(please refer to figure 2,3)
Connect power line: use screw driver to unscrew and connect power line according to the mark on the base. "L" is live line and "N" is neutral line.(please refer to figure 4)

- 3 Connect network cable: make network crystal head as per the standard IEEE-568B ,connect crystal head to receiver RJ45 interface. (please refer to figure 5)
- 4 Install the insulating base. (please refer to figure 6)
- 5 Install the accessory screws to the corresponding positions to fix the extender wall plate to the back box. (please refer to figure7)
- 6 Installation is done.(as figure 8)

NOTE: This HDMI Wall-plate Extender following North American wall plate standard 4.5 inch x 2.74 inch (about 114.3 mm×69.6 mm), The wall-plate mounting dimension is 3.28 inch (about 83 mm). If want to use customer's own back box, please choose a back box with a depth of 1.7 inch (about 43 mm) or more to allow for wiring connection.

• Connection

1. One-to-one connection

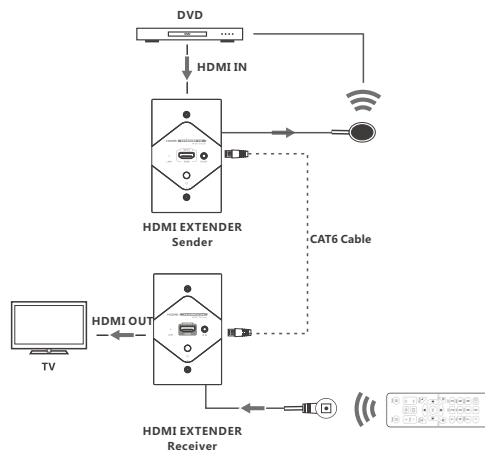

2. One-to-many connection

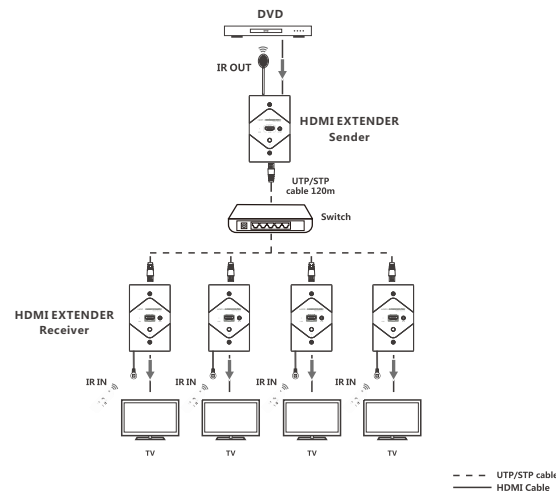

• FAQ

- Q :** TV display "Waiting for connection" on the right corner?
A : Please check if the power supply of transmitter and switcher (if used) is connected, and make sure connecting cable is firmly.
- Q:** Receiver "LINK" indicator is flashing all the time?
A: 1) Make sure network cable connection follows the standard of IEEE- 568B.
 2) Check whether Transmitter has HDMI signal input.
 3) Reset Transmitter & Receiver and reconnect.
- Q:** Receiver "LINK" indicator lights on all the time but no image output?

- A:** 1) Press Receiver "RESET" button to reset the device.
 2) Make sure HDMI cable is well connected with TV.
 3) Plug out/in network cable or repower Receiver.

• Specification

Item	Specification
HDMI signal	Compatible with HDCP
Support resolutions	480i@60Hz, 480p@60Hz, 576i@50Hz, 576p@50Hz, 720p@50/60Hz, 1080i@50/60Hz, 1080p@50/60Hz
Network cable	low resistance and consumption oxygen-free copper core (CAT5/5e/6)
Transmit distance	Full HD resolution 1080p@60Hz up to 120 meters via CAT6 cable
IR remote control	Support 20~60KHz wide frequency IR remote control
Working temperature	0°C ~ 60°C
Power supply	AC 110-240V
Power consumption	TX: 3.5W RX<3W
Product dimension	114(L)x 70(W) x 39(H) mm *2pcs
Weight	150g*2pcs

Disclaimer

The product name and brand name may be registered trademark of related manufacturers.TM and ® may be omitted on the user manual. The pictures on the user manual are just for reference,and there may be some slight difference with the real products.
 We reserve the rights to make changes without further notice to a product or system described herein to improve reliability, function or design.

HDbiT HDMI Wallplate Extender

User manual

